

THE 11TH INTERNATIONAL CONGRESS
ON THE ARCHAEOLOGY OF THE
ANCIENT NEAR EAST

LUDWIG-MAXIMILIANS-UNIVERSITÄT
MUNICH, GERMANY
03 – 07 APRIL 2018

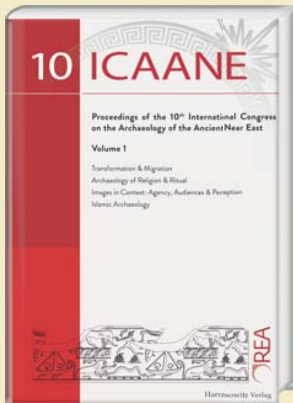



Barbara Horejs (Ed.)

10 ICAANE Wien Proceedings 2016 Volume 1

2018. 706 pages, numerous ill., hc
170x240 mm
ISBN 978-3-447-10996-3
E-Book: ISBN 978-3-447-19742-7
each ca. € 128,- (D)

Volume 2

2018. 664 pages, numerous ill., hc
170x240 mm
ISBN 978-3-447-10997-0
E-Book: ISBN 978-3-447-19742-4
each ca. € 128,- (D)

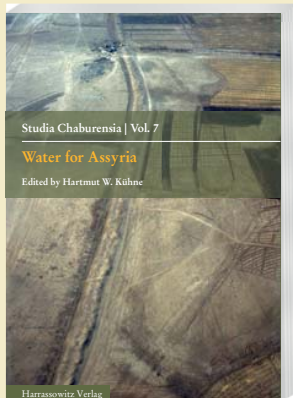

Hartmut Kühne (Ed.)

Water for Assyria

Studia Chaburensia 7

2018. Ca. 190 pages, 80 ill., pb
170x240 mm
ISBN 978-3-447-10989-5
E-Book: ISBN 978-3-447-19740-3
each ca. € 48,- (D)

Peter Pfälzner, Michel al-Maqdissi (Hg.)

Qatna-Studien

Forschungsergebnisse und vergleichende
Untersuchungen des deutsch-syrischen
archäologischen Projekts auf dem Tall
Mišrife

5: Peter Pfälzner, Jochen Schmid

Der Königspalast von Qatna

Teil I: Chronologie, Grundriss,
Baugeschichte und Bautechniken

Mit Beiträgen von Eva Geith, Fidaa Hlal,
Tulip Abd el-Hay, Simone Riehl, Heike Dohmann,
Tina Köster und Katleen Deckers

2018. Ca. 410 Seiten, 215 Abb., 6 Beilagen,
23 Tabellen, inkl. 94 Tafeln, gb
235x305 mm
ISBN 978-3-447-11022-8
Ca. € 168,- (D)

Der in den 1920er Jahren vom französischen
Ausgräber Robert du Mesnil du Buisson ent-
deckte Palast der bronzezeitlichen Königs-
stadt Qatna ist in seiner Monumentalität und
seinen baulichen Besonderheiten einzigartig
in der Tradition königlicher Palastbauten des
2. Jahrtausends v.Chr. im Vorderen Orient.
Von 1999 bis 2010 wurden das Gebäude
und große Teile des antiken Stadtgelän-
des (modern: Tall Mišrife) im Rahmen eines
syrisch-italienisch-deutschen Koopera-
tionsprojektes erneut untersucht. In diesem
Zusammenhang konnten die Architektur des
Palastes, seine Baugeschichte, seine Aus-
stattung und seine Funktionen grundlegend
neu bewertet werden.

6: Eva Geith, Tulip Abd-el Hay, Jochen Schmid

Der Königspalast von Qatna

Teil II: Architektur, Stratigraphie, Keramik
und Funde des westlichen Zentralbereichs

Mit Beiträgen von Stephanie Döpfer, Ivana
Puljiz, Tina Köster, Simone Riehl, Emmanuelle
Vila, Heike Dohmann, Katleen Deckers, Thomas
Richter, Ferhan Sakal, Felix Höflmayer, Aaron
A. Burke, Brian N. Damiata, John Southon und
Giulia Baccelli

2018. Ca. XL, ca. 740 Seiten, 242 Abb., 10 Beilagen,
135 Tabellen, inkl. 171 Tafeln, gb
235x305 mm
ISBN 978-3-447-11023-5
Ca. € 228,- (D)

7: Stephanie Döpfer

Keramikassemblagen der Späten Bronzezeit aus dem Königspalast von Qatna und eine vergleichende Betrachtung zeitgleicher Keramik Westsyriens und der Levante

2018. XXX, ca. 568 Seiten, 135 Abb., 12 Anhänge mit
Tafeln und Tabellen, 1 Klapptafel, 45 Tabellen, gb
235x305 mm
ISBN 978-3-447-10957-4
Ca. € 178,- (D)

8: Sarah Lange, Jochen Schmid, Anne Wissing

Der Königsgruftkomplex von Qatna

Teil 1: Befunde und Fundverteilung
des Korridors und der Vorkammer

Mit Beiträgen von Elisa Roßberger, Emmanuelle
Vila, Alexander Ahrens, Valeria Paoletti,
Stephanie Döpfer, Otto Cichocki, Ivana Puljiz,
Ahmad A. al-Rawi, Katleen Deckers,
Simone Riehl, Bernhard Knibbe und
Isabella Tillich

2018. Ca. 380 Seiten, 289 Abb., 17 Tafeln,
5 Klapptafeln, 3 Beilagen, gb
235x305 mm
ISBN 978-3-447-11021-1
Ca. € 148,- (D)

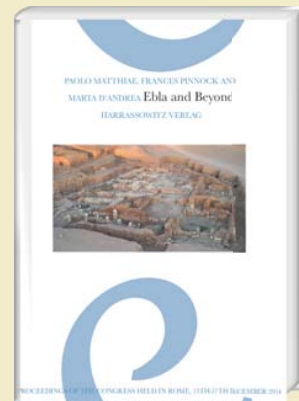

Paolo Matthiae, Frances Pinnock,
Marta D'Andrea (Eds.)

Ebla and Beyond

Ancient Near Eastern Studies after Fifty
Years of Discoveries at Tell Mardikh
Proceedings of the International Congress
Held in Rome, 15th-17th December 2014

2018. VII, 521 pages, ca. 240 ill., hc
170x240 mm
ISBN 978-3-447-11000-6
E-Book: ISBN 978-3-447-19744-1
each ca. € 98,- (D)



The 11th International Congress
on the Archaeology of the Ancient Near East

03 – 07 April 2018

Ludwig-Maximilians-Universität
Munich

Follow us on Twitter

[@11icaane](https://twitter.com/11icaane)
[#11icaane](https://twitter.com/11icaane)



Supported by

DFG Deutsche
Forschungsgemeinschaft



LUDWIG-
MAXIMILIANS-
UNIVERSITÄT
MÜNCHEN



VERLAG  PUBLISHERS
HARRASSOWITZ

e*quinox*





Welcome Address

Dear Guest,

We warmly welcome you at the 11th ICAANE in Munich!

For the next days you will have the opportunity to exchange your ideas about the fascinating past of the Near East with more than 700 scholars from 40 countries.

We, the members of the organizing committee, did our best to prepare an agreeable setting for the conference. 600 lectures will be presented in up to 14 parallel sections and workshops. Since the lecture rooms are all very close and the lectures will start at the time indicated in the programme, it will be possible to switch between sessions. Further research is presented on over 70 posters.

There will be ample space for meetings and social gatherings during the coffee breaks and two evening receptions.

All the necessary information is summarized in the 11ICAANE programme and in the information sheets in your conference map.

For any further questions or help, please turn to the conference bureau in A 120. The programme and abstracts can be found at <http://www.icaane2018.vorderas-archaeologie.uni-muenchen.de/programme/index.html>.

Up-to-date information concerning changes in the schedule will be announced on [twitter](#)  (@11icaane / #11icaane) and on the notice boards in the Main Hall.

We wish you a very pleasant time in Munich and hope you enjoy this week full of new insights into the Archaeology of the Ancient Near East.

Prof. Dr. Adelheid Otto

Head of the Institute for Near Eastern Archaeology

LMU Munich

Host of the 11th ICAANE

In the name of the Organizing Team



Munich's city centre and Maxvorstadt
(university and museum quarter)

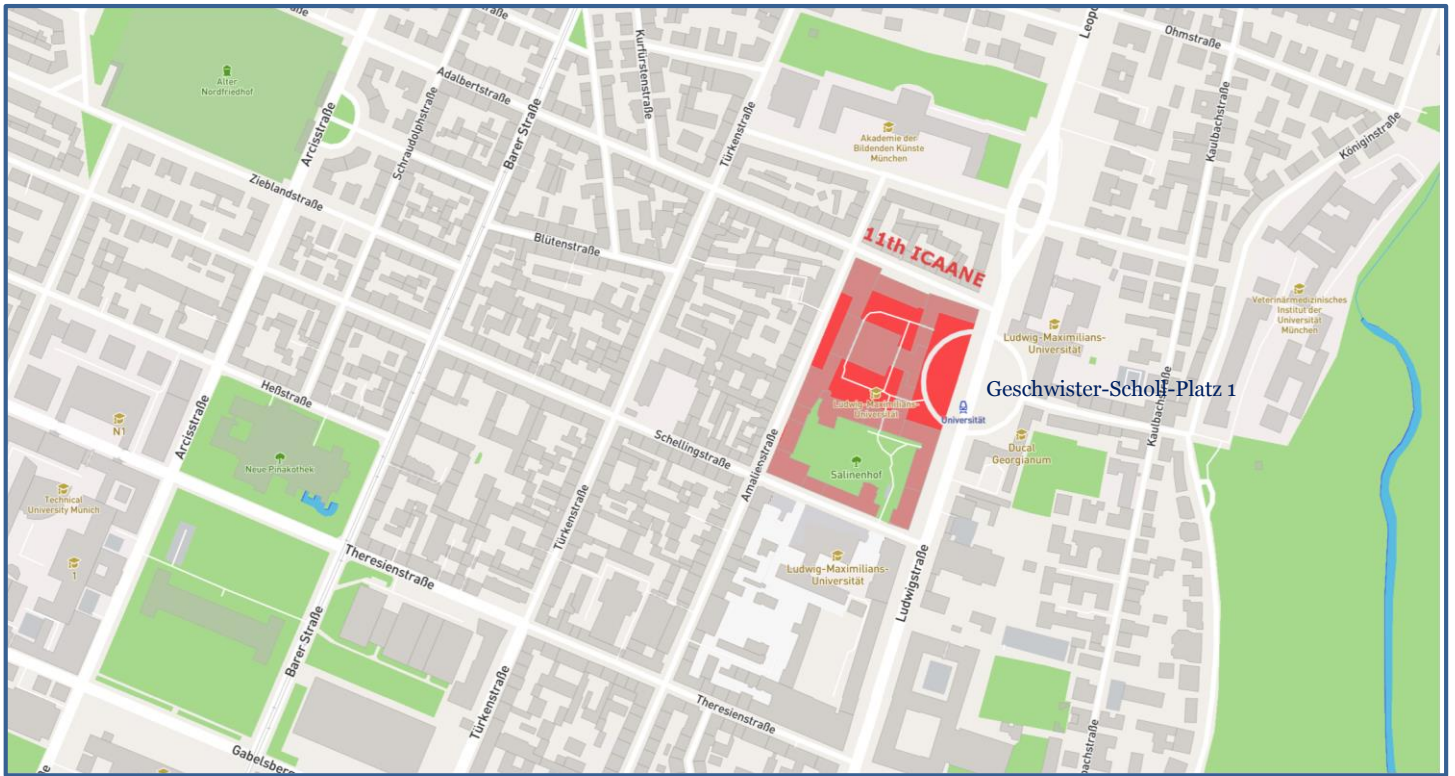

Conference Venue

All sessions and workshops will be held in the **LMU main building** (Geschwister-Scholl-Platz 1), close to the subway station UNIVERSITÄT.

Directions how to get to the LMU main campus can be found here:

http://www.en.uni-muenchen.de/about_lmu/lmu_and_munich/how-to-get-there/index.html

For more information on the public transportation system in Munich including details of timetables, tickets and the MVV network, please check:

<https://www.mvg.de/en.html>

There is a special Airport-City-Day-Ticket for those arriving by plane in Munich:

<https://www.mvv-muenchen.de/en/tickets-and-fares/tickets-daytickets/airport-city-day-ticket/index.html>

Introduction to the LMU München:

https://www.en.uni-muenchen.de/about_lmu/index.html

BAR PUBLISHING

FIND OUT MORE

[www.barpublishing.com/
publish-with-bar.html](http://www.barpublishing.com/publish-with-bar.html)

VISIT OUR BOOTH

at the ICAANE conference

CONTACT US

 editor@barpublishing.com

 Barpublishing

 @BAR_Publishing

BAR Publishing is a leading publisher of research in archaeology with an extensive and prestigious list of more than 3,600 titles built up over 40 years.

PUBLISH WITH BAR

We welcome quality proposals in all areas of academic archaeology in English, French, German, Spanish or Italian.

- All titles are peer-reviewed
- Unbeatable speed & efficiency from manuscript to publication
- Friendly, experienced editorial team
- Well established sales & marketing network



The 11th ICAANE Organizing Committee

Prof. Dr. Adelheid **OTTO** (Chair)

Dr. Michael **HERLES** (Vice-chair)

Dr. Berthold **EINWAG** Anna **KURMANGALIEV**, M.A.

Prof. Dr. Jörg **FABBINDER** Prof. Dr. Lorenz **KORN**

Dr. Claudia **GRUBER** Dr. Simone **MÜHL**

Martin **GRUBER**, M.A. Prof. Dr. Michael **ROAF**

Simon **HALAMA**, M.A. Dr. Elisa **ROßBERGER**

Prof. Dr. Friedhelm **HARTENSTEIN** Prof. Dr. Walther **SALLABERGER**

Dr. Kai **KANIUTH** Dr. Robert **SCHIESTL**

Dr. Florian **KNAUB** Ilona **SPALINGER**

The ICAANE International Scientific Committee

Prof. Dr. Manfred **BIETAK** – Member of the Austrian Academy of Sciences

Prof. Dr. Marian **FELDMAN** - Johns Hopkins University

Prof. Dr. Hartmut **KÜHNE** – Free University of Berlin

Prof. Dr. Jean-Claude **MARGUERON** – École Pratique des Hautes Études

Prof. Dr. Wendy **MATTHEWS** – University of Reading

Prof. Dr. Paolo **MATTHIAE** – Sapienza University of Rome

Prof. Dr. Diederik **MEIJER** – University of Leiden

Prof. Dr. Adelheid **OTTO** - Ludwig-Maximilians-Universität

Prof. Dr. Frances **PINNOCK** - Sapienza University of Rome

Prof. Dr. Ingolf **THUESEN** – University of Copenhagen

Prof. Dr. Cristina **TONGHINI** – Università Ca'Foscari, Venezia

Prof. Dr. Irene **WINTER** – Harvard University

General Information

All sessions and workshops will take place in the LMU main building (Geschwister-Scholl-Platz 1), close to the subway station UNIVERSITÄT.

Registration

Please have your congress badge with you whenever attending an ICAANE event. It allows you to attend the sessions, coffee breaks and receptions. Without a badge you may be refused entry.

Registration opens on Tuesday, the 3rd of April, at 8:30 am in the main building of the LMU. The **conference office** is located on the first floor (A 120). It is open daily from 8:30 until the end of the day's lectures.

Earlier registration is possible on Monday, the 2nd of April, in the "Historicum" building from 4:00–8:00 pm. (Amalienstraße 52, located in the back of the main building of the LMU).

From the 3rd of April onwards, you can register every day directly in the conference office (A 120) of the main building. You may purchase a ticket for the conference for 280,00 € (regular fee) and 130,00 € (student fee), if you have not done so already.

We also provide one-day-tickets for 100,00 € (regular fee) and 60,00 € (student fee).

Twitter

You can follow us on [twitter](#)  (@11icaane / #11icaane). There you will get in touch with changes, news and other special information.

Programme Changes

Any changes to the programme will be announced on the central board near the info point and digitally via twitter. Please check for changes regularly.

Info Point

If you have any questions or if you require additional information, please ask at the info point in the central hall of the main building or in the conference office on the first floor (A 120).

General Information

Speakers

The time limit for a single lecture is 20 minutes, followed by 10 minutes of discussion.

Please have your presentation ready on a USB-stick in powerpoint or PDF format and deliver the stick well ahead of the time of your talk (at the very latest at the beginning of the break before your talk) to the responsible conference assistant in the respective lecture room. Our staff will make sure your presentation is being uploaded onto the computer.

You can check your presentation in the conference office (A 120) beforehand. You will also be able to print your paper there.

Information for those attending the lectures

Turn your mobile phone to silent mode during the sessions.

Please arrive in good time in the lecture room, so that the lectures can start on time.

Use the rear door for entering or leaving a lecture room if you change rooms during a session.

Posters

Posters are on display on the first floor. You may exhibit your poster as soon as you have registered from Tuesday 9:00 am onwards (pinboards with your name will be prepared).

A Poster Session is scheduled for Friday, the 6th of April, from 1:00–2:00 pm and from 6:00–7:00 pm. Please be present during this time, as a poster evaluation committee will gather information for the Best Poster Award, to be announced during the reception on Friday evening.

Bookstalls

Bookstalls of several publishing houses are located on the ground floor and on the first floor.

Archaeology

Equinox Publishing

Journal of Islamic Archaeology

Editor

Bethany J. Walker, University of Bonn

Book Review Editor

Stephane Pradines, Aga Khan University London

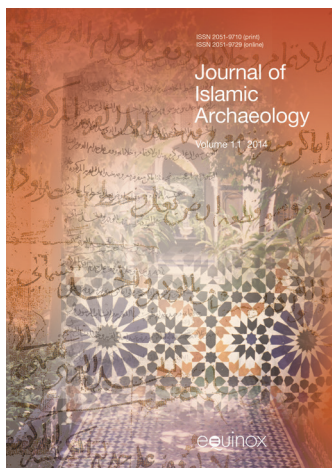

Journal of Islamic Archaeology is the only journal devoted to the field of Islamic archaeology on a global scale. In the context of this journal, 'Islamic archaeology' refers neither to a specific time period, nor to a particular geographical region, as Islam is global and the centre of the 'Islamic world' has shifted many times over the centuries. Likewise, it is not limited by a single methodology or theoretical construct.

The journal offers field and ceramic reports, and studies from other disciplines that are of direct relevance to Islamic archaeology, such as historical geography, art history, history, numismatics, ethnography, and environmental studies.

2 issues per year ISSN 2051-9710 (print) / ISSN 2051-9729 (online)

Visit the journal online at equinoxpub.com/JIA

Journal of Mediterranean Archaeology

Editors

A. Bernard Knapp, Cyprus American Archaeological Research Institute

John F. Cherry, Brown University

Peter van Dommelen, Brown University



Journal of Mediterranean Archaeology deals with the entire multicultural world of Mediterranean archaeology. It publishes material that deals with the social, politico-economic and ideological aspects of local or regional production and development, and with social interaction and change in the Mediterranean. The editors encourage contributions dealing with contemporary approaches to gender, agency, identity and landscape, and welcome material that covers both the theoretical implications and methodological assumptions that can be extrapolated from the relevant archaeological data.

2 issues per year ISSN 0952-7648 (print) / ISSN 1743-1700 (online)

Visit the journal online at equinoxpub.com/JMA

Regional Approaches to Society and Complexity

Edited by Alex R. Knodell and Thomas P. Leppard

MONOGRAPHS IN MEDITERRANEAN ARCHAEOLOGY

Regional Approaches to Society and Complexity



Edited by Alex R. Knodell and Thomas P. Leppard

This volume considers regional approaches to social complexity from a variety of perspectives and at a global scale. John F. Cherry has been a key figure in regional-scale inquiry and broader disciplinary interfaces throughout his career, producing, mentoring, and inspiring a remarkably diverse body of work, which nevertheless remains oriented around this central theme. While Cherry's work is the inspiration for this volume and the papers within it, this should not be seen as a traditional festschrift, or piecemeal homage to the honorand's career.

Rather, it aims to explore this core concern of regional approaches to society and complexity in comparative perspective, first in the Aegean, then branching out to the wider Mediterranean, New World, and finally reflecting on relevant issues of concern to all archaeologists working at levels above the site.

2018 374pp 246 x 174mm Illus.

hb ISBN 9781781797396 / pb ISBN 9781781795279

eBook ISBN 9781781795859

FORTHCOMING BOOKS

Historical Consciousness and the Use of the Past in the Ancient World

Edited by John Baines, Henriette van der Blom, Tim Rood and Yi Samuel Chen

Nineteen linked essays on uses of the past in prominent and diverse cultures in ancient civilizations across the world from leading experts in Ancient Near Eastern Studies, Sinology, Biblical Studies, Classics, and Maya Studies. This volume situates the rise of formal modes of historiography within a larger context of the development of historical consciousness and a wider web of intercommunicating discourses.

2019 340pp 254 x 178mm Illus.

hb ISBN 9781781796566 / pb ISBN 9781781796573 / eBook ISBN 9781781796580

Exploring the Holy Land: 150 Years of the Palestine Exploration Fund

Edited by David Gurevich and Anat Kidron

Since its founding meeting in 1865 in London, the Palestine Exploration Fund scholars have conducted systematic explorations of Jerusalem and the Holy Land. Marking the 150 years since the PEF emerged, this volume provides a retrospective on its endeavours in the light of contemporary archaeological research.

2018 256pp 254 x 203mm Illus.

hb ISBN 9781781797068 / eBook ISBN 9781781797075

For more information about our titles in archaeology visit www.equinoxpub.com

equinox

Wireless Internet Connection

Eduroam

Please install eduroam on your devices via the Eduroam Configuration Assistant Tool (CAT) and select your home institution. Your device will identify a valid eduroam access point and log-in automatically. Your password for your online identity is provided to you by your home institution. Wherever you see 'eduroam' appear in your list of Wi-Fi networks, you can get online.

How to connect:

WLAN Name: eduroam

Password: Provided by your Home Institution

BayernWLAN

The LRZ supports the initiative 'BayernWLAN' with the provision of infrastructure and thus contributes to the expansion of the network: More than 2500 access points of the Munich Scientific Network provide access to BayernWLAN. Internet users can now log in to @BayernWLAN free of charge via the LRZ access points (see the map on <https://www.wlan-bayern.de/#/> for the locations of the access points in the city).

How to connect:

WLAN Name: @BayernWLAN

After choosing the WLAN you will be asked to connect to the network by clicking the "connect" button [Verbinden] in order to accept the terms of use.

M-WLAN: Free WiFi at Munich open spaces

Also, a collaboration of Stadtwerke München, the municipal energy supplier, M-net, the Munich internet and telecommunication provider as well as muenchen.de, the official Website for the City of Munich, have set out to provide great open spaces like the Marienplatz with free wireless LAN. It's for free and it's fairly easy to use.

How to connect:

WLAN Name: M-WLAN Free Wi-Fi

After choosing the WLAN you will be asked to connect to the network by clicking the "connect" button to accept the "terms of use".

You will be automatically logged off after one hour.

Follow us on Twitter

@11icaane
#11icaane



Social Events

Reception at the Glyptothek

Tuesday, 3rd of April 2018, 19:00–22:00

The Tuesday night reception will take place at the Glyptothek (Königsplatz 3, 80333 München).

To get from the University to the Glyptothek, Munich's museum of Greek and Roman sculpture, you can either walk through the museum district (about 15 min.) or take a bus (Bus 150 direction "Hauptbahnhof Nord", get in at the stop "Universität" at Schellingstr./Leopoldstr. and out at "Königsplatz". The closest subway stop is KÖNIGSPLATZ. Alternatively, you may take the subway U3 or U6 from UNIVERSITÄT southbound to SENDLINGER TOR, and change into the U2 or U8 westbound to KÖNIGSPLATZ).



Reception at the Main Building of the Ludwig-Maximilians-Universität Munich

Friday, 6th of April 2018, 19:00–22:00

The Friday evening reception will take place in the LMU main building (Geschwister-Scholl-Platz 1), close to the subway stop UNIVERSITÄT.

Receptions are open to registered participants. Please take your badge!

Special Events

Tuesday, 3rd of April 2018

10:00–12:45

Opening Session of the 11th ICAANE

Thursday, 5th of April 2018

18:30–20:00

Panel discussion Cultural Heritage

Friday, 6th of April 2018

13:00–14:00 & 18:00–19:00

Poster Session

Saturday, 7th of April 2018

14:00–15:00

Closing Session of the 11th ICAANE

Amalienstr.

Adalbertstr.

Ludwigstr.

Universität
(Ausgang A)

- Section 2
- Section 3
- Section 4
- Section 5
- Workshops
WS 4 on April 4
WS 8 on April 5
WS 14 on April 6
WS 19 on April 7
- Workshops
WS 1 on April 4
WS 5 on April 5
WS 11 on April 6
WS 17 on April 7
- Workshops
WS 10 on April 5
WS 16 on April 6



Ground Floor

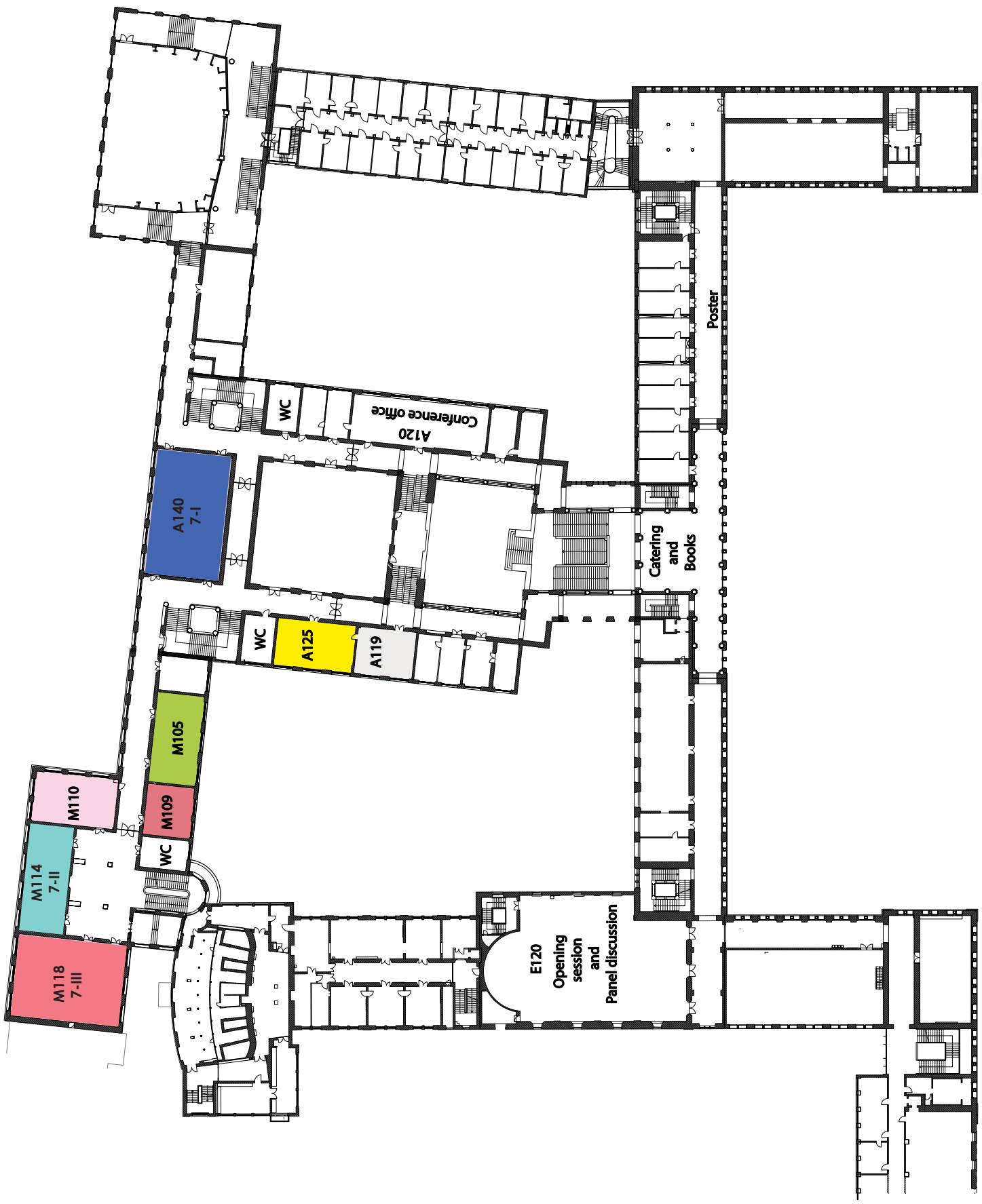

- Section 1
- Section 6
- Section 7
- Section 8
- Workshops**
 WS 3 on April 4
 WS 7 on April 5
 WS 13 on April 6
 WS 18 on April 7
- Workshops**
 WS 9 on April 5
 WS 15 on April 6
- Workshops**
 WS 2 on April 4
 WS 6 on April 5
 WS 12 on April 6

First Floor

Tuesday, 3rd of April 2018 – Sections

8:30 onwards	Registration (Main building of the Ludwig-Maximilians-Universität Munich)
10:00 – 10:45	Welcome Hans van Ess (Vice-president of the Ludwig-Maximilians-Universität Munich) Paolo Matthiae (Head of the International ICAANE Committee) Adelheid Otto (Head of the Organizing Committee) Michael Herles (Vice-chair of the Organizing Committee)
10:45 – 11:15	Key note: Shaping the Living Space Ian Hodder
11:15 – 11:45	Coffee
11:45 – 12:15	Key note: Mobility in the Ancient Near East Roger Matthews
12:15 – 12:45	Key note: Images in Context Ursula Calmeyer-Seidl
12:45 – 14:00	Lunch

	Section 1 – A 125 Mobility in the Ancient Near East	Section 2 – A 021 Images in Context	Section 3 – M 018 Archaeology as Cultural Heritage	Section 4 – A 014 Engendering Near Eastern Archaeology
Chair	Ilan Sharon	Marta Luciani		Elisa Roßberger
14:00 – 14:30	Arkadiusz Marciniak Mobility of people and ideas in the Near East in the second half of the seventh millennium BC. The Late Neolithic Çatalhöyük in its regional and pan-regional context	Vittoria Dall'Armellina Images of a new Aristocracy. A koinè of symbols and cultural values in the Caucasus, Anatolia and Aegean during the Bronze Age		Karen Sonik Minor and Marginal? Model and Transgressive Women in Mesopotamia's Pictorial and Literary Arts
14:30 – 15:00	Pamela Fragnoli and Giulio Palumbi The Handmade Red-Black Burnished ware from Arslantepe (Malatya): investigating multi-scaled phenomena of mobility through ceramic materiality	Alexander Donald Cypriot Elaborate Style glyptic in review		Timothy Harrison The 'Lady of Tayinat' and Female Representation in Neo-Hittite Art
15:00 – 15:30	Mariacarmela Montesanto Lost in transition: The Late Bronze-Iron Age pottery assemblage in Tell Atchana/Alalakh	Anna Paule Adoption and Adaptation of Near Eastern Iconography in Ancient Cyprus. The Winged Sun Disc and Related Symbols		Vladimir Emelianov LBAT 1593 and Gender Aspects of the Mesopotamian Cultic Calendar
15:30 – 16:00	Ulf-Dietrich Schoop and Jessica Hendy The emergence of intensive dairying as a socioeconomic strategy in Chalcolithic Anatolia	Francesca Meneghetti What could be a miniature? Investigating miniature oxhide ingots from Late Bronze Age Cyprus		Sevgül Cilingir Cesur The Perception of Masculinity and Femininity in Hittite Rituals
16:00 – 16:30 Coffee				
Chair	Philipp Stockhammer	Ianir Milevski	Antonietta Catanzariti	Alexander Tamm
16:30 – 17:00	Giota Barlagianni Prehistoric Palettes from Mesopotamia and Aegean	Ariel Vered (Rosenblum) Taking over the reins: a mural painting from Arslantepe revisited	Elisabeth Monamy The mediation of Near Eastern Archaeology as cultural heritage	Eva Schmalenberger Women in Neo-Assyrian Palaces: The case of Nimrud/Kalḫu
17:00 – 17:30	Mustafa Kibaroglu et al. On the Origin of Red Lustrous Wheel-made Ware (RL): Preliminary Results of Chemical, Sr and Nd Isotopic Analysis and Archaeological Interpretation	Izak Cornelius The Material Imagery of Sam'al and Gözân – A Tale of Two Cities	Robert Bewley and Jennie Bradbury Endangered Archaeology in the Middle East & North Africa: Remote Sensing, Training and Cultural Heritage in the MENA region	Kent Fowler, Elizabeth Walker, Jon Ross, Haskel Greenfield, Aren Maeir The age and sex of Early Bronze Age potters from Tell es-Safi/Gath, Israel, Israel
17:30 – 18:00	Mark Iserlis and Raphael Greenberg Contact Between First Dynasty Egypt and Specific Sites in the Levant: New Evidence from Ceramic Analysis	Renate Marian van Dijk-Coombes The Architectural origin of Mesopotamian Standards in Uruk and Jemdet Nasr Period Iconography	Jana Anvari Neolithic doom: Reseraching modern perceptions of the prehistoric transition to agriculture as negative heritage	
19:00 – 22:00	Reception at Glyptothek, Königsplatz 3, 80333 München			

Tuesday, 3rd of April 2018 – Sections

Registration (Main building of the Ludwig-Maximilians-Universität Munich)	8:30 onwards
Welcome Hans van Ess (Vice-president of the Ludwig-Maximilians-Universität Munich) Paolo Matthiae (Head of the International ICAANE Committee) Adelheid Otto (Head of the Organizing Committee) Michael Herles (Vice-chair of the Organizing Committee)	10:00 – 10:45
Key note: Shaping the Living Space Ian Hodder	10:45 – 11:15
Coffee	11:15 – 11:45
Key note: Mobility in the Ancient Near East Roger Matthews	11:45 – 12:15
Key note: Images in Context Ursula Calmeyer-Seidl	12:15 – 12:45
Lunch	12:45 – 14:00

Section 7 – A 140	Section 7 – M 114	Section 7 – M 118	
Field reports I	Field reports II	Field reports III	
Roger Matthews	Enrico Ascalone	Elena Devecchi	Chair
Cinzia Pappi and Constanza Coppini From Ahazum to Idu: The Archaeological Survey of Koi-Sanjay/Koya (Iraqi Kurdistan)	Jebrael Nokandeh and Mahdi Jahed Rescue Archaeology of Nay Tepe, Iran: Gorgan Plain	Flemming Højlund The collapse of the Dilmun Kingdom and the Sealand Dynasty	14:00 – 14:30
John MacGinnis The Darband-i Rania Archaeological Project	Takuro Adachi A Chronological Division of the Iron Age III Period at the Tappe Jalaliye Site in Gilan, Northern Iran	Abdulmeer al-Hamdani The Settlement and Canal Systems in the Lower Southern Mesopotamia during the First Sealand Dynasty (1721-1340 BCE)	14:30 – 15:00
Antonietta Catanzariti and Adam Maskevich Ban Qala: A Late Chalcolithic site in the Qara Dagh Valley in Iraqi-Kurdistan	Tayebeh Almasi et al. Tepe Yalfan Hemedan- Site in Iron Age III	Daniel Calderbank Sealand Period Pottery at Tell Khaiber: Standardised Vessels and Dispersed Communities of Practice	15:00 – 15:30
Juliette Mas A Complete Pottery Sequence From the Late Chalcolithic till Islamic Times in Iraqi Kurdistan: New Discoveries at the Site of Bash Tapa	Mostafa Dehpahlavan The Newly Discovered Cemetery of Iron II Age in Qareh Tepe of Segezabad	Mary Shepperson The Sealand building at Tell Khaiber: A first analysis of monumental architecture from the Sealand State	15:30 – 16:00
Coffee 16:00 – 16:30			
Arnulf Hausleiter	Claudia Beuger	Berthold Einwag	Chair
Karen Radner, Janoscha Kreppner and Andrea Squitieri The Peshdar plain project 2015-2017: Investigating a major Assyrian settlement on the Empire's eastern frontier		Franco D'Agostino and Licia Romano Seven Excavation Campaigns at Abu Tbeirah	16:30 – 17:00
Jean-Jacques Herr Pottery Technological Analysis for the Neo-Assyrian Period in the Peshdar Plain	Marzieh Mehrabani Özarik tepesi: A Parthian Site in Central Arshaq of Ardabil Province	Davide Nadali and Andrea Polcaro Italian Archaeological Expedition to Nigin, Southern Iraq: New Results from Recent Excavations	17:00 – 17:30
Alan Farahani An Archaeobotanical Analysis of Long Term Changes in Agricultural Practice at Kani Shaie, Iraqi Kurdistan	Reza Nafari and Aboozar Kazemi Introducing and Classification of the Kaftari Period Pottery		17:30 – 18:00

Reception at Glyptothek, Königplatz 3, 80333 München	19:00 – 22:00
--	---------------

Wednesday, 4th of April 2018 – Sections

	Section 1 – A 125 Mobility in the Ancient Near East	Section 2 – A 021 Images in Context	Section 3 – M 018 Archaeology as Cultural Heritage	Section 4 – A 014 Engendering Near Eastern Archaeology	Section 6 – M 105 Shaping the Living space
Chair	Susan Cohen	Frances Pinnock	Amy Richardson	Ian Hodder	Wendy Matthews
9:00 – 9:30	Remzi Yağcı The Presence of the Phoenicians, Phrygians, Assyrians and Greeks in the Late Bronze Age in Cilicia: An Archaeological Assessment	Hermann Genz Towards a Definition of the EBA Glyptic Styles from the Central Levant: New Evidence from Tell Fadous-Kfarabida (Lebanon)	Hussam Zahim Mohamed The Archaeological Museum in Iraq between present and future)	Wolf-Rüdiger Teeegen and Michael Schultz The people from the PPNB site Nevalı Çori	David Eitam The Natufian, Hunter-Gatherer or Food Preparing Society? The Architectural Remains of Natufian Huzuq Musa, Jordan Valley
9:30 – 10:00	Konstantinos Kopanias A Reappraisal of the Greek Migration in Cilicia and Pamphylia during the EIA	Valentina Tumolo The seal-impressed jars in the Levant during the Early Bronze Age: from production to use. Visual perception and cultural connections	Franco d'Agostino and Licia Romano UNESCO in Iraq: the Case of Ur	Eline M.J. Schotsmans Gender differences and the funerary use of pigments at Neolithic Çatalhöyük (7100-6000 cal BC)	Sarah Dermeh Shaping architecture through colors
10:00 – 10:30	Neil Erskine Crossing the data-theory bridge: identifying routes and interpreting experiences in Middle Bronze Age Anatolia	Nadeshda Knudsen What was the Purpose of Figurines? Reflections on the Possible Significance of Zoomorphic Figurines from Tel Bet Yerah	Reed Goodman, Robert Bryant and Holly Pittman A New Tool for Recording and Analysis: Integrating Evidence from Heritage, Current and Landscape Field Work	Katarzyna Harabasz Beyond the social pattern. The life cycle theory in studying of human osteobiography. A case from the Neolithic Çatalhöyük	Athina Gerochristou Less than 5 m ² to live in? Some considerations on the small circular buildings of the Halaf Culture
10:30 – 11:00	Wesley Theobald Before the (Old) Assyrians came: A new assessment of Kanesh's involvement in Early Bronze Age trade networks	Giulia Tucci Style vs. function: contexts and consumption of jewelry in the Late Bronze Age southern Levant	Stuart Campbell, Stefan Hauser, Robert Killick and Jane Moon Mapping and protecting Charax Spasinou, southern Iraq	Akira Tsuneki Difference in occupation and violence by gender in the Kerkh Neolithic Society, Northwestern Syria	Aroa García-Suárez Defining early village space: integrated micro-contextual analyses of buildings and open areas at Boncuklu, Central Anatolia
11:00 – 11:30 Coffee					
Chair	Mary Shepperson	Manfred Bietak	Aaron Schmitt	Wolf-Rüdiger Teeegen	Elizabeth Stone
11:30 – 12:00	Yağmur Heffron Assyrians <i>in situ</i> ? Changing mobility and the archaeology of Kaneshan religion	Benedetta Bellucci The Two-Headed Eagle on Ancient Near Eastern Seals	Emma Cunliffe Archaeologists and the military: reassessing cooperation 13 years after Iraq	Yuko Miyauchi Where were the children buried? Reconsidering childhood in the Near Eastern prehistory from age and buried location	Bill Finlayson Process, progress, people and places in the early Neolithic
12:00 – 12:30		Sarah Jarmer Scott and Sarah Kiehl Costello The Birds, the Beasts, and Humanity: Agency and Changing Worldviews in Early Mesopotamian Glyptic Contexts	Ricardo Cabral, Steve Renette and André Tomé The Role of Digital Technologies in the Documentation of the Endangered Archaeological Heritage of the Bazian Valley (Iraqi Kurdistan)	Yoshihiro Nishiaki and Farhad Guliyev Gender perspectives on Neolithization in the Southern Caucasus	Marta Lorenzon Built environment and materiality: synergy and power
12:30 – 13:00	Hannah Lau Mobility, Agro-pastoral Cooperation, and Emergent Social Complexity in the Halaf Period: Evidence from Animal Management Practices at Domuztepe	Ahmed Fatima Kzzo Serpents on Old Syrian Cylinder Seals from Ebla	Alexander Johannes Edmonds Rediscovering "Zagrosology". In Search of a Lost Discipline	Paul Yule Gender, age and social rank of the Samad Late Iron Age population (Sultanate of Oman): nothing new?	Nathalie Kallas Powerful buildings and building power. The case of the MBA palaces in the Levant
13:00 - 14:00 Lunch					
Chair	Catherine Marro	Megan Cifarelli	Jane Moon		Silvana di Paolo
14:00 – 14:30	Ruben Davtyan Glass vessels from Achaemenid-era burials from Lori Berd (Armenia)	Albert Dietz The Iconography of the Ancient Near Eastern Storm-Gods	Pierfrancesco Izzo, Michael Fradley and Andrea Zerbin Snapshots from the past: aerial perspectives of endangered archaeological landscapes in Palestine		Marta Portillo and Wendy Matthews Investigating the use of space and human-animal interactions in early farming built environments: the microarchaeology of livestock dung
14:30 – 15:00	Nathaniel Erb-Satullo Metallurgy and Mobility in the Caucasus	Diederik Meijer Images in Context: The Interpretations of Weather God Imagery	Suzanne Richard The Madaba Regional Archaeological Museum Project (MRAMP): A Strategy to Protect Cultural Heritage in Jordan		Susanna Cereda Investigating the perception of built space through a deposit-oriented approach – the micromorphological study of floors at the site of Arslantepe (Malatya, Turkey)
15:00 – 15:30	Marina Puturidze Mobility Between the South Caucasus and the Near East: in Context of Cultural Interaction Early and Middle Bronze Age Societies	Katharina Zartner Hairy Hero(es)	Marzia Merlonghi Miani Decolonizing archaeology in the Holy Land		Clemens Reichel Domestic or not so domestic: on the multi-functionality of space in domestic structures of Late Chalcolithic northern Syrian cities
15:30 – 16:00	Takehiro Miki Considering mobility of pottery and potters during the Chalcolithic period in Fars, Iran: a comparative analysis of ceramics from Tall-e Gap and Rahmatabad	Eva Götting A Demon's Travel Kit. An Introduction to the Items Depicted on Amulets against the Demoness Lamaštu.	Pascal Flohr Reconsidering and protecting the Pottery Neolithic in the Southern Levant		Andrea Orendi, Katleen Deckers, Jens Kamlah A Phoenician Agrarian Center: Archaeobotanical and archaeological investigations at Tell el-Burak, Lebanon
16:00 – 16:30 Coffee					
Chair	Frank Holt	Izak Cornelius	Federico Buccellati		Margarete van Ess
16:30 – 17:00	Marco Capardoni Settlement Pattern and Mobility in Southern Cappadocia (Niğde Province, Turkey) during the Chalcolithic	Astrid Nunn Are Sumerians and Babylonians different? Skin colours on polychrome statues	Mathilde Mura From Scratch to Smash: Diachronic Analysis of Looting Patterns and Military Occupation of Archaeological Sites in the Middle-East		Reinhard Bernbeck and Barbara Huber Radical Restructuring in an Early Village: Rahmatabad (Fars Province, Iran) in the Fifth Millennium
17:00 – 17:30	Mathilde Jean Tracing ceramic exchanges: how is Tell Arqa (Lebanon) included into the regional trade networks? Some evidences from the EBA	Barbara Couturaud Images of war: materiality and context	Andrew Jamieson and Heather Jackson Community engagement and the Syria: Ancient History – Modern Conflict exhibition and symposium		Piotr Bieliński Space organization of Bahra 1 an Ubaid culture related settlement on Kuwaiti desert
17:30 – 18:00	Alice Vinet and Denis Guilbeau Obsidian on the move: from the sources to the tool	Franciszek M. Stepiński 2D, 3D, and Other Dimensions. On Spatial Scaling in the Art of the Ancient Near East			Friedrich Weigel Facets of Life in an Ancient Oasis Settlement: Contrasting Living Spaces at Tayma (Saudi-Arabia)

Wednesday, 4th of April 2018 – Sections

Section 7 – A 140 Field reports I	Section 7 – M 114 Field reports II	Section 7 – M 118 Field reports III	Section 8 – A 119 Islamic Archaeology	
Glenn Schwartz Dirk Wicke Results of the first two seasons of excavations at Gird-i Qalrakh, a local site in the Shahrizor-Plain	Judith Thomalsky	Helene Sader Marie-Odile Rousset The defensive system of the arid margins of Northern Levant during the Middle Bronze Age		Chair 9:00 – 9:30
Simone Mühl Excavations at Gird-i Shamlu 2015–2017: A Bronze Age and Late Chalcolithic Site in Southern Kurdistan		Sarah Lange-Weber Wooden Boxes Full of Bones and Precious Finds – the Complex Archaeological Record of the Tomb VII in the Royal Palace of Qatna		9:30 – 10:00
Aline Tenu The 2016-2017 Excavation seasons in Kunara (Iraqi Kurdistan)	Alexander Weide The emergence of agriculture outside the Levantine corridor: Chogha Golan (western Iran) and its significance for the Neolithization process in the Near East	Ahmad Sultan New data from Kaškašok III in Northern Syria		10:00 – 10:30
Jumana Alasaad The Early Bronze Age Pottery from Tell Bakrawa and the plain of Shahrizor				10:30 – 11:00
Coffee 11:00 – 11:30				
Marco Iamoni	Luca Peyronel Alexander Tourovets and Mohammad Masoumian Excavations in Teppeh Zarduyan (near Marivan Iranian Kurdistan)	Timothy Harrison Pascal Flohr and Olivier Nieuwenhuys Interpreting the effects of abrupt climate change on prehistoric society: Tell Sabi Abyad and the 8.2 ka event	NN Prof. Dr. Donald Whitcomb and Tawfiq Daadli Early Islamic discoveries at al-Sinnabra (Khirbet al-Karak)	Chair 11:30 – 12:00
Florine Marchand Kunara Lithic Industry: A Preliminary Report	Hassan Moradi Archaeological Survey in Neyriz, eastern Bakhtegan Lake, Fars Province	Sari Jammo Emergence of the cemetery in the Near East: A case study of Tell el-Kerkh, northwestern Syria	Donald Whitcomb Toward an Archaeology of Sasanian Cities	12:00 – 12:30
Régis Vallet Early Uruk Expansion in Iraqi Kurdistan: New Data from Girdi Qala and Logardan	Javad Alaei Moghadam Investigating the Model of Production System and Good Distribution during the Bronze Age of Sistan Based on Archaeological Studies	Alexander Sollee Reinvestigating the Lower Town of Tell Halaf/Guzana	Claus-Peter Haase Stratigraphical Problems in the Early Islamic Madinat al-Far Excavations, 1987-2001	12:30 – 13:00
13:00 – 14:00 Lunch				
Hartmut Kühne Christophe Nicolle New data on the Assyrian triangle urban cultures according to the first results of the Bash Tapa's excavations	Anacleto D'Agostino Saeid Bahramiyan Khervali: An Extensive Middle Paleolithic Workshop in the North of Susiana Plain, West of Central Zagros, Khuzistan, Iran	NN Arwa Kharobi Between death and memory: New evidence for tombs reopening in Urkesh "the Capital of Hourrites" in the first half of the second millennium B.C	Claus-Peter Haase Martina Müller-Wiener et al. Settlements below the plane: Multidisciplinary archaeological surveys in al-Hira (Iraq)	Chair 14:00 – 14:30
Glenn Schwartz Second-Millennium BC Urbanism at Kurd Qaburstan on the Erbil Plain: 2016-2017 Results	Nasim Faizi A New 3D Method to Calculate the Index of Symmetry for the Middle Paleolithic Points: the Mirak Site-a Case Study	Marco Iamoni The Northern Lebanon Project (NoLeP): an archaeological survey of the district of Koura and the area of Tripolis	Tawfiq Daadli Examining the Urban Tissue of a "Lost" Town through Archeology and Historical Documents: The Town of al-Lidd as a Case-Study	14:30 – 15:00
Luca Peyronel and Agnese Vacca Survey and Excavations at Helawa, Southwest Erbil Plain, Kurdistan, Iraq	Meisam Nikzad and Zahra Rajabi Last Hunters and First Farmers in Southeastern of Caspian Sea, Iran	Jennie Bradbury The Koumba Coastal Survey Project, Northern Lebanon	Paul Wordsworth Reconsidering the demise of an early Islamic capital in the southeast Caucasus: Bardha'a and the Kura plain in the 11th-12th century	15:00 – 15:30
Claudia Beuger A buffer zone between Assyria and Urartu? – Report on the preliminary results of the <i>Khalifan Survey Project</i> 2014-2017 (Autonomous Region of Kurdistan)	Mahnaz Sharifi Archaeological Excavation At Cham Routh Tepe, Seimare, Central Zagros		Jaleh Kamalizad Firuzān, an Ilkhanid City south-west of Isfahan. An overview on historical and archaeological data	15:30 – 16:00
16:00 – 16:30 Coffee				
Jörg Fassbinder Marion Scheiblecker Magnetic investigations in the Shahrizor Plain, Iraqi Kurdistan	NN Lily Niakan The Salvage excavation at Cham Papi the Establishment and Cemetery site, Middle and late Bronze Age, central Zagros, Simereh Dam	Hermann Genz Ralph K. Pedersen An Underwater Excavation at Ain al-Mreisseh, Beirut: Reaching Across the Academic-Public Divide	Richard McClary Katie Campbell The City of Otrar and the Mongol Conquest: Resilience and Revival	Chair 16:30 – 17:00
Lidewijde de Jong, Rocco Palermo and Jason Ur Shaping Imperial Spaces. The Erbil Plain from the End of the Assyrians to the Seleucid Empire	Soheil Salamat The Application of Tin-Based and Arsenical Bronze in 4 th and 3 rd Millennium Metallurgy of Iranian Plateau: A New Look	Helen Sader Wine industry at Iron Age Tell el-Burak? New evidence from the 2017 season	Elham Vosouq Babae and Elahe Vosouq Babae Historical & Structural Evolution of the Urban Network of Saveh City in the Safavid Era	17:00 – 17:30
Maria Grazia Masetti-Rouault Late Bronze and Iron Age Levels at Qasr Shemamok: First Evaluations about the impact of the Assyrian Empire Presence in the Region East of Calah	Mohammad Hosein Taheri, Danial Harandi, AIREZA Sardari Identification of pigmentes of Tal-e Mash Karim wall painting at the Chalcolithic site of Iran	Metoda Persin Building 2 at Tell Fadous-Kfarabida (Lebanon): An architectural, stratigraphic and functional study of an Early Bronze Age Building	Serenella Mancini The Pottery <i>Corpus</i> from Estakhr (Fars): Preliminary Results of a New Comprehensive Study	17:30 – 18:00

Wednesday, 4th of April 2018 - Workshops

Room	A 017 WS 1	M 110 WS 2
WS	Arnulf Hausleiter and Steffen Terp Laursen Bronze Age burial practices on the Arabian Peninsula: Interdisciplinary perspectives on cultural contacts and exchange	Enrico Ascalone and Mansur Sajjadi New and old multidisciplinary researches at Shahr-i Sokhta in a historical perspective
9:00 – 9:30	Arnulf Hausleiter – Steffen Terp Laursen At the crossroads? Investigating burial practices on the Arabian Peninsula	Seyyed Mansur Seyyed Sajjadi Summaries of Sixteen Archaeological Campaigns at Shahr-i Sokhta (1997-2016) and the New Archaeological Investigations in 2017.
9:30 – 10:00	Juris Zarins North Arabian Pastoral Nomads of the Early Bronze Age: Their relationship to the Frontier Cities of western Southern Mesopotamia	Enrico Ascalone Results of Excavation and Researches in 2017 Season in Area 33 at Shahr-i Sokhta.
10:00 – 10:30	Emmanuele Petiti Going global. Negotiating Identities in the Bronze Near East: Bioarchaeological case studies	Hossein Moradi – Seyyed Mansur Seyyed Sajjadi Revising Shahr-i Sokhta Period IV.
10:30 – 11:00	Anaïs Chevalier Spatial analysis and burial practices: new insights regarding protohistoric tombs in central and western Arabia	Iraj Beheshti – Seyyed Mansur Seyyed Sajjadi (Y. Sedghi - E. Ameri) Study of Semi-precious Stone in South East Iran. The Case Study of Shahr-e Sukhteh.
11:00 – 11:30 Coffee		
11:30 – 12:00	T. Steimer-Herbet – T. Hofstetter S. al-Duweish – M. Besse Small-scale stone monuments on the Arabian coastline during the Bronze Age	Silvia Festuccia Alabaster Vessels from Building 33: Typology and Petrographic Analysis.
12:00 – 12:30	Steffen Terp Laursen The Royal Mound of A'ali, and the burial custom of Amorite/Dilmunites in Bahrain	Claudia Minniti Preliminary Results from the Study of Animal Remains at Shahr-i Sokhta: New Researches.
12:30 – 13:00	Gianni Marchesi “Arabian” Amorites and Amorite burial customs: The textual evidence	Marzam Ramezani – Seyyed Mansur Seyyed Sajjadi (M. Tavallaci - A. Mohammadi - M. Naderi) Capacity of Genetics Studies in Shahr-i Sokhta Skeletal Remains, 3 th Millennium BC.
13:00 – 14:00 Lunch		
14:00 – 14:30	Michel al-Maqdissi From Ras Shamra-Ugarit to Amrith: Funeral structures on the Syrian coastal region in the Middle Bronze Age	Gholamreza Molwavi – Mahsasadat Makki – Seyyed Mansur Seyyed Sajjadi The Status of Human and Animal Parasitic Infections in the Shahr-e Sukhteh Archeological Site (3200-1800 BC): First Phase of Study.
14:30 – 15:00	Wael Abu-Azizeh Research on cairns and tumuli at Mada'in Salih: Identifying a late 3rd – early 2nd millennium hitherto unknown funerary tradition of northwestern Arabia	Giuseppe Ceraudo (V. Ferrari – P. Guacci – R. Montanaro) Remote and Proximal Sensing at Shahr-e Sokhta. Interim Report.
15:00 – 15:30	Alina Zur Bronze Age Burials at Tayma, NW Arabia: Defining the local	Kourosh Mohammadkhani Geo-magnetic survey at Shahr-i Sokhta.
15:30 – 16:00	Michaela Binder – Marta Luciani The funerary structures at Qurayyah, Saudi Arabia – Bioarchaeological approaches to life and death in Bronze Age Northern Arabia	Tobias Scholz Geo-magnetic survey at Shahr-i Sokhta in 2017 Season.
16:00 – 16:30 Coffee		
16:30 – 17:00	Guillaume Gernez Bronze Age ‘warrior burials’ through the Near East and Arabia	Hossein Sarhaddi Dadian – Abdolkarim Shadmehr New Data-Base Management System in Shahr-i Sokhta.
17:00 – 17:30	Discussion: Perspectives on the future of burial archaeology on the Arabian Peninsula	

Wednesday, 4th of April 2018 - Workshops

A 119	A016	Room
WS 3 Peter M. Fischer and Teresa Bürge Bronze Age Cyprus: Regionalism versus Interculturalism	WS 4 Federico Manuelli and Dirk P. Mielke Late Bronze Age Painted Pottery Traditions at the Margins of the Hittite State	WS
Luca Bombardieri Broadening the circle. Community, industry and intra-island mobility in Middle Bronze Age Cyprus	Federico Manuelli – Dirk Paul Mielke Pottery Traditions in Late Bronze Age Anatolia: an Introduction	9:00 – 9:30
Peter M. Fischer The Late Bronze Age harbour city of Hala Sultan Tekke: Economy and intercultural	S. Yüncel Şenurt – Akçay Atakan Late Bronze Age Painted Pottery and Its Contextual Relationship to the Hittite Levels at Ovaören	9:30 – 10:00
Teresa Bürge Intra-island relations reflected in the local pottery of Hala Sultan Tekke, Cyprus	Dirk Paul Mielke Geometric Painted Pottery of the Second Millennium BC in the Central Black Sea Region	10:00 – 10:30
Lorenzo Mazzotta –Laerke Recht Imported aegean pottery at late bronze age hala sultan tekke, cyprus	Şevket Dönmez Painted Pottery from 7B Architectural Layer in Oluz Höyük: New Evidence and Thoughts on the Late Bronze Age in North-Central Anatolia	10:30 – 11:00
Coffee 11:00 – 11:30		
Paula Waiman-Barak – Teresa Bürge – Peter M. Fischer Provenance Analysis of Late Bronze Age Ceramics from Hala-Sultan Tekke	Federico Manuelli Just a Matter of Style? Late Bronze Age Painted Pottery Traditions in the Upper Euphrates Region: Origins and Significance	11:30 – 12:00
Despina Pilides Inland Cyprus in the Late Bronze Age: Regional or intercultural? Evidence from the region of Agios Sozomenos	Alvise Matessi Between Centre and Periphery: the (Low) Incidence of Painted Pottery in LBA Assemblages from Inland Southern Anatolia	12:00 – 12:30
Laerke Recht Mycenaean ‘Chariot Kraters’ in Cyprus and the Eastern Mediterranean in the LBA	Elif Ünlü Style as Representation of Political Hegemony? A View from the Edge of the Hittite Kingdom	12:30 – 13:00
Lunch 13:00 – 14:00		
	Eric Jean Late Bronze Age Painted Pottery Traditions at Mersin	14:00 – 14:30
	Ekin Kozal Painted Pottery Traditions in Sirkeli Höyük in the 2nd Millennium BC	14:30 – 15:00
	Atilla Engin The Northern Syria Painted Pottery Traditions in the 2nd Millennium BC in the Light of Oylum Höyük Finds	15:00 – 15:30
	Gabriele Giacosa – Valentina Orsi Late Bronze Age Ceramic Traditions in the Islahiye Valley (SouthEastern Turkey). The Combined Evidence from TaşlıGeçit Höyük and Tilmen Höyük	15:30 – 16:00
Coffee 16:00 – 16:30		
	Mara T. Horowitz Painted Pottery Traditions of Late Bronze Alalakh	16:30 – 17:00
	Final Discussion	17:00 – 17:30

Thursday, 5th of April 2018 – Sections

	Section 1 – A 125 Mobility in the Ancient Near East	Section 2 – A 021 Images in Context	Section 3 – M 018 Archaeology as Cultural Heritage	Section 6 – M 125 Shaping the Living space
Chair	Yoshihiro Nishiaki	Stefania Mazzoni	Karel Novacek	Aaron Burke
9:00 – 9:30	Takahiro Odaka et al. From the seventh into the sixth millennium in the Shahrizor, Iraqi Kurdistan: Filling the gap	Diana Stein A New Angle on the Contest Scene: Exploring its Context on Third Millennium BC Seals and Sealings	Youssef Kanjou: The role of Syrian archaeologists and foreign archaeological missions in the protection of the Syrian heritage	Darren Ashby Religious Architecture on the Southern Tigris: Local forms, shared practices
9:30 – 10:00	Manuela Heil Investigating the Nature of Mobility and Transfer in the Western Zagros Region	Alessandro Di Ludovico Alterations and New Locations for Old Themes: On Changing and Traveling Cylinder Seals' Motifs	Nibal Muhesen: The urban heritage damages and the possible aspects of uricide attested during the current Syrian conflict	Marian Feldman Monumental Architecture and the (De)construction of Memory during the Ur III Period
10:00 – 10:30	Amy Richardson Early Neolithic mobility of people and things in the Central Zagros: the evidence from Bestansur	Melissa Ricetti Akkadian motifs in the seals and sealing from Kültepe/Kanesh	Nour A. Munawar: Modern Warfare and Cultural Heritage in Syria and Iraq	Silvana Di Paolo Encoding Space and Place in Old Babylonian Households
10:30 – 11:00	Steve Renette et al. Kani Shaie: A local center within the changing inter-action spheres of the Late Chalcolithic and EBA	Maria Sologubova Family values in Old Babylonian pantheon. Image of the god's spouse in Old Babylonian glyptic	Pascal Butterlin: Mari and the Syrian crisis, facing the unbelievable	Laura Battini Meeting Points in the Old-Babylonian Cities: an Overview from Archaeological and Epigraphical Sources
11:00 – 11:30 Coffee				
Chair	Maria Gabriella Micale	Diana Stein	Mirko Novák	Nigel Tallis
11:30 – 12:00	Michelle de Gruchy Observations on the North Jazira during the Uruk Expansion from a Study of its Routes	Megan Cifarelli, and Roberto Dan The Hasanlu Decorated Belts in Context	Bariş Gür: Route of antiquities illegally removed from Syria and the case of Turkey	Helga Vogel The Riemchengebäude in Uruk-Warka: a monumental grave?
12:00 – 12:30	Georges Mouamar Identification of a new material culture and circulation of potteries stemming from the production centres of the early regional states during the 3rd millennium in Central Syria	Annelies van de Ven Iran and the East – Displaying the Persian Connection	Konstantinos-Orfeas Sotiriou: Fluid as Water: The Various Participants in the Antiquities Smuggling Phenomenon – a Real Threat	Felix Levenson Studying architectural energetics – body and mind in its social setting
12:30 – 13:00	Suzanne Dibo La mobilité de la culture syrienne vers l'Assyrie durant la période néo-assyrienne	Jean-Claude Margueron A propos des temples de Mari Ville II: quelle place pour les images dans l'espace architectural du temple de Ninni-zaza?	Miroslav Melčák, Karel Nováček and Lenka Starková: Monuments of Mosul in Danger Project	Anne-Caroline Rendu Loisel Sensory Landscapes in Akkadian Divinatory Texts
13:00 – 14:00 Lunch				
Chair	Helen Dixon	Astrid Nunn	Adelheid Otto	Alessandro Di Ludovico
14:00 – 14:30	Mohammed Alkhalid Social Vs. Genetic Change; the Formation of the Middle Bronze's Culture in Ebla	Robert Sataev, Liliia Sataeva Liliia and Dubova Nadezhda Plants, animal and human images of Ancient Margiana (Turkmenistan)	NN Report of the General Directorate of Iraq	Margherita Dallai Intramural funerary hypogea as living space: some case studies from Mesopotamia
14:30 – 15:00	Khaled Abu Jayyab Hamoukar as a highland gate way to the lowlands: Mobility and its role in shaping LC1 and LC2 communities	Béatrice Muller A propos des temples de Mari (Ville II) : Hierarchy dans les armées de nacre	Kamal Rashid Report of the General Directorate of Iraqi Kurdistan	Kristen Hopper From the local to the imperial: Landscape transformations between the Late Iron Age and the Islamic period on the Gorgan Plain, northeast Iran
15:00 – 15:30	Samar Shammis The „Syrian“ Tell el-Yahudiyeh Ware	Frances Pinnock Representing the elites in Middle Bronze I-II Ebla	Mohanad Al Sayani Report of the General Directorate of Yemen	Giulio Maresca and Mehdi Mortazavi Looking for the Elusive Iron Age in Iranian Sistan: "Missing Links" and Troubled Human-Environment Interactions
15:30 – 16:00	Kazuya Shimogama People and Graves Before Settlement: Pursuing Early Bronze Age Mobility at Rumeilah on the Middle Euphrates		Ammar Abdulrahman Report of the General Directorate of Syria	
16:00 – 16:30 Coffee				
Chair	Felix Höflmeyer	NN	Pascal Butterlin	Marta D'Andrea
16:30 – 17:00	Heidi Köpp-Junk Frauen auf Reisen im Alten Ägypten	Gunvor Lindström The statue of a Seleucid king from Elymais/Iran. Rediscovered, reassembled, set in context	Ingolf Thuesen / Nicolò Marchetti: Heritage and Threat (HeAT): An EU Joint Project Initiative on Cultural Heritage	
17:00 – 17:30	Mohamed Elsayed Osman Abdollah Caravans, routes, and the cognitive map of Nubia during the Old kingdom	Alessandro Poggio From Collections to Contexts: Typological and Art-Historical Researches on Graeco-Persian Glyptic	Mirko Novák, Andrew Jamieson, Olivier Nieuwenhuijse and Marina Pucci The SHIRIN initiative: past, present and future	Alessandra Caselli Living in the Southern Levant during Early Bronze Age I: reconsidering house types, domestic installations and spatial organization of settlements
17:30 – 18:00	Karin Sowada and Mary Ownby The Old Kingdom Abroad: Petrogr. Results of Imported Ceramic Jars from Giza, Egypt	Mina Rastegar fard and Mostafa Dehpahlavan Position and Dignity of Priests in Elymais Dynasty	Séan Fobbe: RASHID International – Research, Assessment and Safeguarding of the Heritage of Iraq in Danger	Alessandra Gilibert Civic community and public space at Ugarit
18:30 -20:00 Panel discussion Cultural Heritage				

Thursday, 5th of April 2018 – Sections

Section 7 – A 140 Field reports I Ekin Kozal	Section 7 – M 114 Field reports II Dirk Wicke	Section 7 – M 118 Field reports III Winfried Orthmann	Section 8 – A 119 Islamic Archaeology Bettina Fischer-Genz	Chair
Jędrzej Hordecki The TP and TPC Area at Çatalhöyük East in the context of Phrygian and Hellenistic settlement	Alexander Tamm Excavations in Gird-i Kazhaw (Iraqi Kurdistan). Middle Bronze and Late Sasanian Settlement Layers	Yitzhak Paz Excavating A City's Hinterland: A Multi-Disciplinary Research of the Hinterland of Tel Yarmouth during the EBIII	Bethany Walker and Yuval Gadot Agricultural Terracing and Rural Revival in Late Medieval Palestine	9:00 – 9:30
Jarrad William Paul Uğurlu and Ulucak: the tale of two worked bone collections	Pierre Borsdorf A Monumental Sasanian Building at Gird-i Kazhaw (Iraqi Kurdistan)	Shuichi Hasegawa Hidemasa Hashimoto, Hidetoshi Tsumoto and Takuzo Onozuka The excavations at Tel Rekhes, Israel: The results of 2013-2017 seasons	Nuha Agha and Harvé Barbé Archaeozoological Perspectives on Late Medieval Holy Land: Diet and Status in the Mamluk Castle of Safed	9:30 – 10:00
İnan Aydoğan Başur Höyük An Uruk-Related Settlement on the Edge of the Upper Tigris Valley: An Uruk Colony? A Gateway City? Or an Admin. Centre?	Meysam Labbaf-Khaniki, Kristen Hopper and Eberhard Sauer Fortifications and the Defensive Landscapes of Kalat	Vladimir Wolff Avrutis Reevaluation of Chalcolithic burial customs – A Late Chalcolithic Domestic and Burial Site, Southern Levant	Piotr Makowski Life among the ruins. Khirbat edh-Dharib in the Middle Islamic Period	10:00 – 10:30
Sabahattin Ezer New Researches in the North of Fertile Crescent – Adiyaman Region	Eberhard Sauer et al. Interconnected Frontiers: Trans-Caspian Defensive Networks of the Sasanian Empire	Alon Arad High-Resolution Study of the Early Bronze III 'Plaza' at Tel Bet Yerah (Khirbet Kerak) and Its Implications for Migrant/Indigenous Interaction	Hassan Karimian and Zeinab Afzali Water Supply Infrastructures of the Ancient City of Sirjan	10:30 – 11:00
Coffee 11:00 – 11:30				
John MacGinnis	Eberhard Sauer	Ricardo Eichmann	Martina Müller-Wiener	Chair
Nicolò Marchetti New Results for the Bronze and Iron Ages at Karkemish (2016 and 2017 Seasons)	Niloofar Ehteshami A Study on Settlement and Burials Patterns of Faryab Plain in the Parthian and Sassanid Periods	Alexander Ahrens From the Jordan Valley to the Transjordanian Highlands. First Results of the Wadi Shu'aib Archaeological Survey Project	Valentina Vezzoli and Cristina Tonghini The Islamic period settlement in Kurdistan/Iraq: results from the Land of Ninive Archaeological Project	11:30 – 12:00
Virginia Herrmann et al. Zincirli, Turkey: Recent Results from the Chicago-Tübingen Excavations	Alireza Khosrowzadeh, Naser Nowruz Zadeh Chegini and Samer Nazari Description, Classification and Typology of the Excavated Parthian Pottery from Qal'eh-i Yazdigird, Kermanshah Province, Iran	Stephen Bourke From Chalcolithic Village to Canaanite Town: The 2017 Field Season at Pella in Jordan	Mustafa Ahmad Islamic Archaeology in Iraqi Kurdistan: Sulaimaniya Region as a study case	12:00 – 12:30
Hannah Mönninghoff et al. Sirkeli Höyük through the Iron Ages (Eastern Cilicia, Turkey): Results of the Turkish-Swiss Missions Fieldwork in 2016 and 2017	Maryam Esmacili The Analysis and classification of potteries From Tasouj – Kavay Region Fars Province	James Fraser and Caroline Cartwright Investigating rural complexity after urban collapse: new excavations at the late 3rd m. BCE site of Khirbet Um al-Ghozlan, Jordan	Kyra Kaercher Chronology and Social Identity in the Middle and Late Islamic Periods in NE Iraq via the Study of Un-glazed Earthen-wares	12:30 – 13:00
Lunch 13:00 – 14:00				
	Reinhard Bernbeck	Katharina Schmidt	Paul Wordsworth	Chair
				14:00 – 14:30
	Javad Alaei Moghadam et al. Investigating the Origin of Settlements in Farahan Plain Based on the Archaeological Studies	Bernd Müller-Neuhof Challenging the Marginality of the Jawa Hinterland in the 5th/4th Millennium BCE: Hillforts, Agri-culture and Mines in the arid Northern Badia (NE Jordan)	Richard McClary Archaeology of the Object: A Detailed Study of the Production, Decoration and Distribution of <i>Mina'i</i> Wares	14:30 – 15:00
	Leila Banijamali Excavation on Jam Site, Mahalat	Fabrice De Backer The Khirbet al Khalde Archaeological Project: An overview on Land Use and Water Employment in Pre-Islamic Jordan	Nurşen Özkul Fındık and Deniz Yasin Meier Islamic Period Ceramics found in the excavations at Adana/Tepebağ	15:00 – 15:30
	Shima Pourmomeni A Typological Study of Ceramic Wares from Harmangan, a Newly Excavated Neolithic Site in Bavanat Basin, Fars Province, Iran	Zeidan Kafafi and Lucas Petit Artistic expression at Tell Damiyah from the Late Iron Age until the Ottoman Period	Hamidreza Pasha Zanous and Majid Zohoori Some Thoughts on the Iranian-Chinese Maritime Trade in Late Antiquity and Early Islamic period	15:30 – 16:00
Coffee 16:00 – 16:30				
	Regis Vallet	Peter M. Fischer	Katia Cytryn Silverman	Chair
	Maryam Dolati Introducing and Typology of metal objects of Sarm cemetery	Catrenea Hamarnah Between gardens and fields: "And they shall build up a wall" (Jordan)	Amir Gorzalczany and Hagit Torgë Islamic Tomb-stones Reused during the Early Islamic Period from Ramla, Capital of Jund <i>Filastin</i>	16:30 – 17:00
	Niloufar Moghimi and Hossein Davoudi The Rise of Accounting System and Administration in the Central Plateau of Iran during the Fourth Millennium BC	Kathryn Grossman et al. Prehistoric Archaeology in the Polis Region: Survey and Geophysics at Makounta- <i>Voules</i> and Stroumpi- <i>Pigi-Agios Andronikos</i> , Cyprus	Bettina Fischer-Genz A medieval collective burial at Qornet ed-Deir (Jabal Moussa, Lebanon)	17:00 – 17:30
		Andrew McCarthy On the origins of urbanism in western Cyprus: a view from the Palaipaphos hinterland	Giulia Gallio, Steve Renette, André Tomé, Ricardo Cabral A Late Ottoman-period cemetery from Kani Shaie, Sulaimaniyah	17:30 – 18:00
Panel discussion Cultural Heritage 18:30 -20:00				

Thursday, 5th of April 2018 - Workshops

Room	A 017 WS 5	M 110 WS 6	A 119 WS 7
WS	Karin Kopetzky – Zuzanna Wygnanska Middle Bronze Age tombs and their funerary environment from Syria to Egypt	Kai Kaniuth – Sebastien Gondet Achaemenid Residences in Context	Johnny Samuele Baldi, Marco Iamoni, Luca Peyronel and Paola Sconzo The Late Chalcolithic of Upper Mesopotamia and the interaction with Southern Uruk communities: new data and interpretations for a better understanding of the early urban world
9:00 – 9:30	Rafał A. Fetner What bones can tell us about the Middle Bronze Age burial rite: case study from Bakr Awa Iraqi Kurdistan)	Wouter Henkelmann Palaces and residences in the Achaemenid institutional network	
9:30 – 10:00	Zuzanna Wygnanska An ideal Amorite burial? The Middle Bronze Age burial customs from a Mesopotamian perspective	Christopher Tuplin “By appointment to the king.” Royal labels in the Achaemenid landscape	1. Ecology, Economy and Settlement Patterns Tim Boaz Bruun Skuldbøl – Carlo Colantoni Unravelling early urbanism and the dynamics of cultural encounters in Late Chalcolithic Mesopotamia. New insights from the Danish Archaeological Expedition to Iraq (DAEI)
10:00 – 10:30	Andrea Polcaro The Ideology of Death in Ebla during the Old Syrian Period: Exclusive and Inclusive Funerary Traditions and Beliefs in Tell Mardikh during the Middle Bronze Age	Rémy Bouchariat Achaemenid pavilions and find spots of Achaemenid-style column bases: distribution, definition and functions	Paola Sconzo – Marco Iamoni The Uruk presence in the Upper Tigris of Iraqi Kurdistan and the interaction with local LC societies
10:30 – 11:00	Panayiotis Andreou When the lights went out, did they always close the door behind them? A discussion of results derived by comparative analysis of ritual activities in funerary deposits across Syria/North Palestine during the Middle Bronze Age	Nabil Iboerrida The “pavilions” as elements of an Achaemenid urban planning/settlement system	Maria Bianca D’Anna Un air de famille. Preliminary notes on the Late Chalcolithic period in the Shahrizor Plain (Slemani, Kurdistan)
11:00 – 11:30 Coffee			
11:30 – 12:00	Claude Doumet-Serhal Mortuary practices and feasting activities on Sidon’s College site	Sébastien Gondet – Kourosh Mohammedkhani Pasargadae: Report on the recent archaeological activities (2015–2017)	2. Techniques, Production Systems and Social Organization Judith Thomalsky Lithics as interacting entities – or - how to define an urban lithic industry?
12:00 – 12:30	Stephen Bourke BA Tombs at Pella in Jordan: The Intramural Graves and the Extramural Cemetery	Martin Gruber – Jörg Faßbinder Archaeological survey and geophysical prospection in the surroundings of the Achaemenid residence at Karacamirli (Azerbaijan)	Daniele Moscone Current Research on Chipped Stone Artifacts from Tell Helawa (Iraqi Kurdistan)
12:30 – 13:00	Raz Kletter Rishon le Zion: a “Central Place” Cemetery?	Marie-Laure Chambrade – Stephanie Metz Achaemenid residences in their landscape: a cross study between Pasargadae and Karacamirli	Michael Lewis Social Transformations and Modes of Ceramic Production during the Late Chalcolithic in the Shahrizor Plain, Iraqi Kurdistan: A Geochemical and Petrographic Study
13:00 – 14:00 Lunch			
14:00 – 14:30	Susan Cohen Transfer and continuity in the Middle Bronze Age tombs at Gesher	Winfried Held Die Residenz eines persischen Satrapen in Meydancikkale, Kilikien	Agnese Vacca – Luca Peyronel Household Economy and Labour Organisation: Pottery Production and the Emergence of Social Complexity at the Late Chalcolithic site of Tell Helawa, Iraqi Kurdistan
14:30 – 15:00	Rachel Sparks The Necessities of Death? Funerary patterns and Practice in the Bronze Age Intramural burials of Tell el-’Ajjul Area G	Alireza Askari Chaverdi – Pierfrancesco Callieri The Monumental Gate at Tol-e Ajori: a new evidence of an imperial architectural presence in the Persepolis plain	Johnny Samuele Baldi Bits of Uruk before and outside the Uruk colonial sphere. The Qara Dagh area and some early thoughts on a reassessment of the Uruk expansion
15:00 – 15:30	Paula Phillips The Cemetery 1000 at Tell Fara South	Dietrich Huff Persepolis: Ritual or secular?	3. Complexities in Contact Augusta McMahon Resourcing the City: Tell Brak LC 2-3 Container Sealings
15:30 – 16:00	Karin Kopetzky Buried in Avaris – a fusion of Egyptian and Near Eastern Funerary Customs	Amanda Dusting Qal’eh Kali. Achaemenid residence?	Catherine Marro Beyond the Great Mountains: the integration of Late Chalcolithic Caucasian Communities into Middle-Eastern dynamics
16:00 – 16:30 Coffee			
16:30 – 17:00		Hilary Gopnik Betwixt and Between: The unfinished palace of Oğlanqala Period III	Francesca Balossi Restelli What complexity? Late Chalcolithic developments at the site of Arslantepe in the Upper Euphrates region
17:00 – 17:30			17:00 Discussion

Thursday, 5th of April 2018 - Workshops

A 016 WS 8	M 109 WS 9	A 022 WS 10	Room
Philipp W. Stockhammer and Ianir Milevski Palaeogenetics and Cultural Archaeological Perspectives on the Eastern Mediterranean Bronze and Early Iron Age	Raffaella Pappalardo, Costanza Coppini and Raffaella Pierobon-Benoit “Dark Ages”? Identifying Markers of Transition in Mesopotamia and the Near East on a Diachronic Scale	Noemi Borrelli and Giulia Scazzosi After the Harvest. Storage strategies and food processing in Bronze Age Mesopotamia	WS
I. Milevski – Philipp W. Stockhammer Introduction To The Topic & Proposing New Paths Of Integrating Archaeology And Palaeogenetics Johannes Krause Introducing The Max Planck Harvard Research Center For The Archaeoscience Of The Ancient Mediterranean	9:15 Raffaella Pierobon Benoit Introduction	9.15 – 9.30 Introduction	9:00 – 9:30
Chair: Johannes Krause Topic I: Arslantepe	Costanza Coppini Introduction to the problematic of transitions in the Second and First Millennium BC in the history of studies	Klaus Wagensonner Grain, sheep, and fish: Insights into methods of food processing and storing based on the early textual evidence	9:30 – 10:00
Marcella Frangipane Population Dynamics At Late Chalcolithic And Early Bronze Age Arslantepe From An Archaeological Perspective	Dominik Bonatz Tell Fekheriye in the Late Bronze Age: Markers of Cultural Demarcation and Social Identification During Periods of Change	Alexander Pruss Grain storage and grain distribution in the 3rd millennium BC Upper Mesopotamia	10:00 – 10:30
Chair: Marcella Frangipane Topic II: Alalakh	Sebastian Haidler – Cinzia Pappi Between Assyria and Adiabene: Cultural Transitions in the Valley of the Lower Zab	Armando Bramanti Before the Harvest? Land-grain Accounts in Early Dynastic Umma	10:30 – 11:00
K. A. Yener – T. Ingman Archaeological Analysis Of The Bronze Age Burials From Alalakh			
Coffee 11:00 – 11:30			
R. S. Shafiq – S. Eisenmann Bioarchaeological Perspectives On Middle And Late Bronze Age Burials From Alalakh	Raffaella Pierobon Settlement changes in Tell Barri (VI-IV century B.C.)	Henrike Backhaus De-centralized storage facilities in the residential quarters at Early Bronze Age Tell Chuera	11:30 – 12:00
Chair: K. A. Yener Topic III: “Mycenaean” Vs “Minoan”	Johannes Köhler De-marginalising Seleucid populace: Towards an archaeology of consumption	Noemi Borrelli In and Out: Institutional storage and control network in the Ur III province of Lagaš	12:00 – 12:30
Joseph Maran Questioning “Mycenaean” And “Minoan” From An Archaeological Perspectiveom Alalakh			
Alissa Mitnik et al. Genetic Origins Of The “Mycenaean” And The “Minoan”	Discussion	Tate Paulette It’s all about the ingredients: Archaeological perspectives on beer and brewing in Mesopotamia	12:30 – 13:00
Lunch 13:00 – 14:00			
Chair: Joseph Maran Topic IV: “Philistines”	Raffaella Pappalardo Transition or not transition? Identifying the early Islamic pottery assemblage in Northern Mesopotamia. An overview from Tell Barri (Syria)	Arkadiusz Sotysiak Bioarchaeological evidence of grain import to the area of Terqa during the Bronze Age	14:00 – 14:30
Aren Maeir – Philipp W. Stockhammer Current Archaeological Approaches To The Philistines			
Daniel M. Master – Sherry C. Fox The Philistine Cemetery At Ashkelon	Valentina Vezzoli The Early Islamic Period in Kurdistan/Iraq: clues and limitations in ceramic analysis	Aron Dornauer Tasty intermediates – Prepared instant intermediates for the Mesopotamian food and beer production	14:30 – 15:00
Ianir Milevski – Dmitry Yegorov – Svetlana Talis – Yossi Nagar – Patricia Smith – Liora K. Horwitz The Iron Age Cemetery Of Tel Erani, Socio-Cultural Diversity In The Southern Levantine Coastal Plain?	Karel Nováček A pottery stasis within a social transformation? A case of the early-Islamic-period ceramics in North-eastern Mesopotamia	Giulia Scazzosi “Eat the Bread, Enkidu”: Bread-baking and the role of bakeries in late 3rd-early 2nd millennium BC Mesopotamia	15:00 – 15:30
Michal Feldman A Genetic Study Of Bronze And Iron Age Populations From Present-Day Israel	Final Discussion and Concluding Remarks	Elena Devecchi Granaries and the management of stored crops in Kassite Babylonia	15:30 – 16:00
Coffee 16:00 – 16:30			
Final Discussion		Elsa Perruchini, Claudia Glatz, Jaime L. Toney Beer production and consumption in the Kassite period: An interdisciplinary study of second millennium BC drinking vessels from the Sirwan/Upper Diyala Region	16:30 – 17:00
		17.00 – 17.30 Final Discussion	17:00 – 17:30

Friday, 6th of April 2018 – Sections

	Section 1 – A 125 Mobility in the Ancient Near East	Section 2 – A 021 Images in Context	Section 5 – A 014 Societal Contexts of Religion	Section 6 – M 105 Shaping the Living space
Chair	Marina Puturidze	Harriet Martin	Walther Sallabeger	Juliette Mas
9:00 – 9:30	Maria Guagnin The Neolithic of northern Arabia: Local adaptation and long-distance exchange of ideas	Elisabeth Katzy The terracotta figurins at Tell Halaf in the Hellenistic period. Between continuity and change	Somayeh Asadi Tashvigh and Rahmat Abbasnejad Seresti Archaeology of Childhood. A Review of Jar Burials of Children at The Center of Iranian Plateau during Sialk IV 2 period (3200-2900 BC)	Kiersten Neumann A Sense of Time in Place: Temple Construction and Renovation in Assyria
9:30 – 10:00	Sara Pizzimenti Sumer in Arabia. Tracing the Jemdet Nasr Presence in the Arabia Peninsula and the Red Sea through Pottery and Cylinder Seals	Amir Golani Beyond Ornamentation: Contextualizing Research of Personal Adornment in the Ancient Near East	Megumi Tashiro An Experimental Trial to Reconstruct of Burial Custom from Hasankeyf Höyük	Julia Linke A royal shaping of space – The building activities of the Urartian Kings
10:00 – 10:30			Sarvenaz Parsa The Significance of the natural environment in Zoroastrianism and its reflection in Sasanian sacred architecture	Holly Winter South Levantine 'Courtyard' Palaces: Questions of Form and Function
10:30 – 11:00	Lloyd Weeks et al. Saruq al-Hadid: A Persistent Temporary Place in Late Prehistoric Southeastern Arabia	Ayşe Gül Symbol of the sun	José Luis Blesa Cuenca Kulträume der arischen Völker aus der frühen Eisenzeit	Federico Buccellati Energetic Cost Calculator for Ancient Architecture
11:00 – 11:30 Coffee				
Chair	Romana Harfouche	NN	Karen Sowada	Nicolo Marchetti
11:30 – 12:00	Stefan Smith Morphological Similarities in Late Chalcolithic and Early Bronze Age Sites across the Syro-Jordanian Steppes: A Mobility of Ideas and/or People?	Francesca Minen Fighting the enemy in Assyria. A brief study on Neo-Assyrian archeological and textual evidence (XI-VII s. BCE)	Sara Caramello Some considerations about the religious interactions between Aramaic-speaking people and Egyptians	Jason T. Herrmann The Urban Development of Sam'al (Zincirli) from the Perspective of Remote Sensing
12:00 – 12:30	Sergio Taranto Husking tray: a shared technology between the Late Neolithic communities of the Near East?	Elisabeth Wagner-Durand The Assyrian Kings, their Images and the Ontologies of Philippe Descola	Willis Monroe Investigating Historical Religious Groups with Digital Methods: The Database of Religious History	David Kertai The Architecture of the Gaze: Palace J/K at Zincirli
12:30 – 13:00	Francesca Manclossi Neither diffusion of ideas nor simple trade of objects: the moving of specialized Canaanite blade knappers during the Early Bronze Age in the Southern Levant	Vahid Askarpour Archaeological Enactive Semiotics of Assyrian Sacred Tree	Jacob Ashkenazi Family rural Churches in Late Antique Palestine: a socio-archaeological study	Hartmut Kühne Reconstruction and Function of the Middle Assyrian Building P at Dur-Katlimmu
13:00 – 14:00 Lunch				
13:00 – 14:00 Poster Session				
Chair	Shuchi Hasegawa	Anna Kurmangaliev	NN	Carola Metzner-Nebelsick
14:00 – 14:30	Celia Bergoffen Late Cypriot Bichrome Ware as an Expression of Commercial Mobility	Ryuji Shikaku Image and metalworking technology: Bimetallic sword from northern Iran	Fabian Heil The Role(s) of Ritual Practice in Bronze Age Cyprus	
14:30 – 15:00	Melissa A. Kennedy and Kamal Badreshany Mobility, 'Caliciform' Ware and the Changing Cultural Landscapes of the Levantine Late 3rd Mill. BC	Helene Maloigne Beard or no beard: racializing Sumerians and Semites		Clelia Mora Cappadocia, a "Hidden" Landscape: "Underground World" and Neo-Hittite Evidence
15:00 – 15:30	David Ben-Shlomo Cooking Pots in Iron Age II Judah: Confined or Mobile Distribution	Evelyn Kutzer The Socio-Cultural Value and Function of Music. On musical instruments and their performances in Mesopotamia of the 3rd m. BCE from an archaeological, iconographical and philological perspective	Madeleine Mumcuoglu and Yosef Garfinkel Eternal Cultic Symbol: The Recessed Opening	Anahita Mittertrainer Sasanian cities – images of political power
15:30 – 16:00	Wolfgang Zwickel Roads around the Sea of Galilee from the Neolithic to the Persian period	Cory Crawford Dimensions of Iconicity in Iron Age Syro-Anatolian Imagetexts	Öznur Özmen Eye Idol As A Ritual Object	Simon Halama Interpreting Alalah's Late Bronze Age Palaces. Some suggestions on intended function and meaning
16:00 – 16:30 Coffee				
Chair	Amir Golani	Elizabeth Wagner-Durand		Alexander Pruß
16:30 – 17:00		Cheikhmous Ali Reed Constructions in Mesopotamian Glyptic: State of the Question		Hardy Maaß The emergence of a professional group in the Early Iron Age: engineering seismologists
17:00 – 17:30	Hannah Parow-Souchon Mobility and land-use in the Upper Palaeolithic of the Levant	Harriet Martin Correlating Abu Salabikh Tablets, Pottery and Glyptic		Mehmet Ali Yilmaz New Data about Bronze Age Settlement of Erzincan/Altıntepe
17:30 – 18:00	Sumio Fujii Built-in Pier-house at the Rock shelter Settlement of Jabal Juhayra. New Insight into the PPNB Pastoral Transhumance in Southern Jordan	Elisa Roßberger and Anna Kurmangaliev Semanticizing Ancient Near Eastern Seals and Sealings: The DigANES Project		Najmeh Hassas The Living space in nomadically architecture
18:00 – 19:00 Poster Session				
19:00 – 22:00 Reception at LMU				

Friday, 6th of April 2018 – Sections

Section 7 – A140 Field reports I	Section 7 – M 114 Field reports II	Section 7 – M 118 Field reports III	Section 8 – A 119 Islamic Archaeology	
Eric Jean	Sebastian Gondet	Nawala al-Mutawalli	Cristina Tonghini	Chair
Anna Lanaro Kınık Höyük: New Information from Southern Cappadocia	Alessandra Cellerino and Enrico Foietta The sanctuary and cemetery at Kal-e Chendar, Shami, in Khuzestan (Iran)	Elizabeth Stone Excavating Ur	Katia Cytryn-Silverman The First Mosque of Tiberias: Religious Architecture After the Conquest	9:00 – 9:30
Pavol Hnila Rainer Maria Czichon, Jörg Klinger and Dirk Paul Mielke Excavations in the Hittite city of Nerik (Oymaagac Höyük/Turkey)	Marjan Mollabeyrami et al. A Study and Analysis of Animal Bones of Iron Age III and Achaemenid Periods in Qareh Tepe of Segezabad	Emily Hammer The City and Landscape of Ur: An Aerial, Satellite, and Ground Reassessment	Markus Ritter Umayyad Audience Halls Reconsidered	9:30 – 10:00
T.E. Şerifoğlu et al. Rough Times: The Lower Göksu Archaeological Salvage Survey	Yaghoub Mohamadifar A new attitude to rock arts of Hamadan province, western Iran, regarding archaeological researches	Adelheid Otto The LMU Munich excavations 2017 at the South Mound of Ur	Robert Smith The Abila Icon Fragment and the Creation of Hierotopy in a Byzantine/Umayyad Pilgrimage Complex	10:00 – 10:30
Haluk Sağlamtimur and Metin Batihan The Materialization of Power: Başur Höyük Early Bronze Age Graves	Mousa Sabzi, Roya Tajbaksh and Hossein Rezaei azandaryani Investigation and analysis of rock arts at Dodangeh, Borujerd, Western Iran	Anne Löhnert School tablets from Ur	Ignacio Arce The Preliminary phasing of the Maqam an-Nabi Musa	10:30 – 11:00
Coffee 11:00 – 11:30				
Cinzia Pappi	Sebastian Gondet	Abdulmeer al-Hamdani	Bahram Ajorloo	Chair
Mehmet Isikli and Oguz Aras A New Royal and Religious Space in Ayanis Citadel: The Hall with Podium		Dominique Charpin Epigraphical discoveries at Ur, 2017 season: a survey	Yadollah Heidari and Mohamad Zarei The Effects of Parthian and Sassanid Coins on the Iconography of the Qajar Period: Mo'aven-ol Molk Tekyeh, Kermanshah	11:30 – 12:00
Anacleto D'Agostino and Valentina Orsi Excavations at Uşaklı Höyük	Esmail Hemati Azandaryani Investigating effects of elements on formation of troglodytic structures of Hamadan province	Mike Charles For the people? Household level plant consumption and disposal in Old Babylonian Ur	Neginsadat Tabatabaei Religious Propaganda in the Form of Islamic Inscriptions	12:00 – 12:30
Atila Türker Devret Höyük: An Anatolian Village in Central Black Sea Region	Mohesn Zeynivand Deh Luran plain after around half a century (Archaeological review Survey), southwest of Iran	Melina Seabrook Spatial Variation in Ur Faunal Remains	Christian Fuchs Archaeology and Building Archaeology on the Rab'e Rashidi Complex in Tabriz, Iran	12:30 – 13:00
Lunch 13:00 – 14:00				
Poster Session 13:00 – 14:00				
Dirk Paul Mielke	Alexander Sollee	Holly Pittman	NN	Chair
Yutaka Miyake Excavations at Hasankeyf Höyük, an Early Neolithic site in southeast Anatolia	Elham Moradi et al. The Role of Metal Crafts in Sociocultural Systems of Gohar Tepe	Nicolò Marchetti, Basim Jabbar and Federico Zaina QADIS. Preliminary report on the 2016 and 2017 Iraqi-Italian survey seasons in the south-eastern region of Qadisiyah (Iraq)	Aila Santi Reinterpreting the <i>mişr</i> : New Insights for a Revised Chronological Attribution of the Mosque- <i>dar al-imara</i> Complex in Küfa	14:00 – 14:30
Deniz Yasin-Meier Urban Archaeology in Cilicia, Tepebağ Höyük/Adana Excavation. A General Overview From The 2th To The 1st Millennium BC.	Bijan Bajoorvand Pottery changes during the period from Susa I to Susa II based on studies from potteries discovered in the terminal susa A phase in Tappeh Sangar, Khuzestan	Berthold Einwag The survey at Tell Fāra / Şuruppak	Bahram Ajorloo Archaeological Expedition to the Arch of Alishāh in Tabriz 2017: An Approach to a Revision of Previous Investigations	14:30 – 15:00
Lynn Welton Continuity and Innovation During The Iron I at Tell Tayinat: Local Traditions, Sea Peoples and the Land of Palistin in Broader Perspective	Mohammad Amin Mirghaderi et al. Settlements And Population Fluctuations During The Prehistoric In The Bavanat River Basin Based on archaeological Survey	Abbas al-Hussainy Preliminary results of the 2016-2017 Mi-Enfil-Arakhtum Survey	Amin Moradi Correlations Between Northwest Iran and Ilkhanid Architecture in Introducing Ottoman Mosque Archetypes Between 14th and 15th Centuries	15:00 – 15:30
Charlotte Diffey, Amy Bogaard and Mike Charles 'Farming the City': Agriculture and storage in the Late Bronze Age		Philippe Quenet Old and New: The Urukian Occupation at Eridu	Rami Alafandi and Asiah Abdul Rahim The Aleppine Houses, Its Designs and Decorated Interiors during the Ottoman Era	15:30 – 16:00
Coffee 16:00 – 16:30				
Rafal Kolinski	Jessica Giraud		Bethany Walker	Chair
Tatsundo Koizumi, Hitoshi Ojima and Ayami Yoshida An Experimental Analysis of Ubaid and Late Chal-colithic Pottery. Reproduction of clay and pigments	Hamid Zairi Archaeological Survey of Kharg Island (North of the Persian Gulf, Iran)		Simone Struth An interdisciplinary method for a new reading of the Abbasid stucco panels from Samarra	16:30 – 17:00
Sevinç Günel A Center of Intercultural Relations in Western Anatolia: Çine-Tepecik	Maria Pia Maiorano and Francesco Gench The Late Neolithic encampment of HD-2 - RaMs al-Hadd, Sultanate of Oman (fourth-third millennium BCE)		Ana Marija Grbanovic Beyond the Stylistic Idiosyncrasies: Identity and Mobility of Ilkhanid Stucco Craftsmen in the Isfahan region c.1300	17:00 – 17:30
Silvia Alaura and Susanne Heinhold-Krahmer Die „Tagebuchblätter“ von E.O. Forrers Türkeireise (1926) – Überarbeitung für ihre Edition	Agnieszka Pieńkowska Iron Age settlement in the region of Qumayrah (Oman)		Amir Hossein Karimiy The Phenome-non of Pseudo-Stucco: Carved clay decorations in the historic city of Meybod, Iran	17:30 – 18:00
Poster Session 18:00 – 19:00				
Reception at LMU 19:00 – 22:00				

Friday, 6th of April 2018 - Workshops

Room	A 017	M 110	A 119
WS	WS 11 Marta Luciani Mobility in the Arabian Peninsula	WS 12 Masoud Kasiri, Bahram Ajourloo, Judith Thomalsky, Moslem Mishmastehi Archaeometrical Studies in Iran: State of Research and Perspectives	WS 13 Élise Luneau – Lynne M. Rouse Redefining Interaction and Mobility in Prehistoric Southern Central Asian Archaeology
9:00 – 9:30	Khalid Alasmari AlUyanah: Neolithic site, In the northwest of the Kingdom of Saudi Arabia	E. Pernicka Archaeometallurgical researches in central Iran the Basis of Fluorine, Uranium, and Nitrogen content	Élise Luneau – Lynne M. Rouse Introduction: Arenas of Mobility and Interaction in Prehistoric Southern Central Asia, with an example from Bronze Age Ceramic Traditions
9:30 – 10:00	Sumio Fujii et al. Post-Neolithic Cultural Sequence in NW Arabia: New Perspective from Wadi Sharma sites	N. Nezafati – M. Momenzadeh – K. Ahmadi A Road Map for the Ancient Mining and Metallurgical Studies in Iran	Section 1. Defining Mobility in the Central Asian Environment Roberto Arciero Water and Mobility: How different communities in prehistoric southern Turkmenistan viewed and managed the same water resources
10:00 – 10:30	Michèle Dinies – Reinder Neef, et al. The Economy of Oases: a View from Botany	M. B. Kasiri Relative Dating of Chehrabad (Iran) Salt Mine Mummies on	Susan Pollock – Jana Eger Mobility in Early Village Societies: Monjukli Depe and southern Turkmenistan in the Early Aeneolithic
10:30 – 11:00	Marta Luciani Mobility and the genesis of oasis settlement	Z. Foroozan – A. Bräuning – K. Pourtahmasi The Potential of Tree Rings for Reconstructing Climate History in Northern Iran	Marjan Mashkour – Julie Daujat – Shiva Sheikhi – Sonja Kroll – Denis Fiorillo – Sarieh Amiri – Margareta Tengberg – Johanna Lhuillier – Julio Bendezu-Sarmiento Pastoralism and Animal Management at Ulug Depe during the Bronze and Iron Ages
11:00 – 11:30 Coffee			
11:30 – 12:00	Khalid Douglas – Nasser Al-Jahwari – Kimberly D. Williams The Early Bronze Age Umm an-Nar community in Dahwa (DH1) mobility and exchange between Magan and Indus on the Batinah Coast, northern Oman	H. Fazelinashli – M. W. Gregg Agricultural Societies at the Intersection of the Southern Coastal Plain of the Caspian Sea and Foothills of the Alborz Mountains in Northern Iran	Robert Spengler Bearing Fruit in Archaeobotanical Studies of the Prehistoric Silk Road
12:00 – 12:30	Alessandra Avanzini – Enrica Tagliamonte Long distance routes and contacts in Salut through the millennia	S. Riehl Addressing the role of environmental fluctuations in ancient resource management by plant remains and stable carbon isotope measurements (Chogha Golan)	Barbara Cerasetti Who Interacted With Whom? Redefining mobility in Bronze Age southern Turkmenistan
12:30 – 13:00	Kimberly D. Williams – Nasser Al-Jahwari – Khalid Douglas Umm an-Nar Burial Rituals at Dahwa, Northern Oman	W. Matthews High-resolution analyses of early agricultural built environments in the Zagros: integrating archaeobotany, micromorphology and geochemistry	Discussion (section 1)
13:00 – 14:00 Lunch break			
14:00 – 14:30	Laura Machel Qurayyah Painted Ware – an “interconnected” pottery of the 2nd millennium BCE	A. Nagel Elamite Polychromies: New Research on Pigment-Stratigraphy from Chogha Zanbil and Susa	Section 2. Mobility of People: Movement and Pathways. Sonja Kroll – Marjan Mashkour – Élise Dufour – Denis Fiorillo – Julio Bendezu Sarmiento – Johanna Lhuillier – Céline Bon Where did they come from and where did they go? Stable isotope analyses of Bronze Age societies in Central Asia and Iran
14:30 – 15:00	Andrea Intilia – Francelin Tourtet Area O, Tayma, Saudi Arabia	V. Martinez Ferreras E. Luneau New Pottery Analyses from southern Uzbekistan: a trans-chronological Perspective	Gian Luca Bonora Nomadic Pastoralists and Traders along the Lapis Lazuli and Turquoise Routes
15:00 – 15:30	Zbigniew Fiema Al-Qusayr And The Hijazi Trade Routes	M. Razani – B. Ajourloo The experimental archaeology of Islamic potteries from Qaradagh, Azerbaijan, NW Iran	Kyle G. Olson FETE-LCA: Supercomputer simulations of trade routes in the ancient Near East
15:30 – 16:00	Jérôme Rohmer – Ahmad Al-Jallad Thāj, a commercial and cultural crossroads in Eastern Arabia	M. Emami – Y. Sedghi Set on the Fire over 4th millennium BC: Preliminary Multi-Analytical Approach to the Ceramic Production Technology in Tal-i Eblis	Lynne M. Rouse Space Invaders: New insights on long-term sedentary-mobile interactions in prehistory from recent research in southern Turkmenistan
16:00 – 16:30 Coffee			
16:30 – 17:00	Caroline Durand Comparing the trade networks of Northwest and Eastern Pre-Islamic Arabia: recent data from Hegra and Thaj	N. Gailhard – M. Bode The Copper Mines of Nakhchivan: an archeometallurgical and archaeometry	Section 3. Interaction(s) through Material Culture Elizabeth Brite Were Khorezmian Potters Nomadic? Pottery production in the Khorezm Oasis as an indicator of syncretic culture, 1st millennium B.C. – 1st millennium A.D.
17:00 – 17:30	Guillaume Charloux Aspects of Mobility in Dumat al-Jandal (Northwestern Arabia)	A. Aal – T. Stöllner The salt-mine and salt-mummy project of Chehrabad (Iran): Recent interdisciplinary research	Luca Forni Religion and Spiritual Life in the Bronze Age: New evidence of interactions between mobile pastoralists and sedentary farmers in the Murghab region (southern Turkmenistan)
17:30 – 18:00	Jérémic Schiettecatte Out of Arabia. When trade and diplomacy made Southerners cross the desert	M. Orange – F.-X. Le Bourdonnec – R. Berthon – V. Bakhshaliyev – C. Marro Looking north: first insights into the consumption of obsidian from the Neolithic to the Bronze Age in Nakhchivan	Discussion (sections 2 and 3)
18:00 – 18:30	Romolo Loreto – Simona Berardino The Islamic ware from Dumat al-Jandal. An outline of the VII-XVI cent. oasis trade system		

Friday, 6th of April 2018 - Workshops

A 016	M 109	A 022	Room
WS 14 Silvia Prell – Manfred Bietak The Enigma of the Hyksos	WS 15 Hanan Charaf – Helen M. Dixon – Ann Killebrew Phoenicians in Phoenicia: New Directions and Recent Discoveries	WS 16 Igor Kreimerman – Ruth Shahack-Gross Reconstructing Destruction: New Trajectories in the Macro- and Micro-Archaeological Research of Destruction Layers in the Ancient Near East	WS
Marta D'Andrea Before the Cultural Koiné: Contextualizing Interculturality in the “Greater Levant” during the Late Early Bronze Age and the Early Middle Bronze Age			9:00 – 9:30
Manfred Bietak Tracing the Origins of the Hyksos Elite of Egypt as seen from a Comparative Study of Sacred and Palatial Architecture	Chairs: Hanan Charaf – Helen Dixon Northern Levant session	9:55 Igor Kreimerman – Ruth Shahack-Gross Introduction	9:30 – 10:00
	Helen Dixon Digitally Reconstructing Phoenician Sacred Space in the Northern Levant		
Silvia Prell So-called “Warrior Burials” in the Fertile Crescent	Maria-Eugenia Aubet Excavations at Tyre	Steven Ortiz Gezer Destructions: A Case Study of a Border City	10:00 – 10:30
Silvia Gomez Senovilla Urban Morphology and Urban Syntax at Tell el-Dab'a	Ida Oggiano Excavations at the Site of Jemjim, Southern Lebanon	Tobias Helms Killing in the Name of – the destruction of Tell Chuera's main ceremonial complex in the EJ 3a-period	10:30 – 11:00
Coffee Break 11:00 – 11:30			
Anna Wodzińska Tell el-Retaba during Second Intermediate Period. Pottery and People	Tatiana Pedrazzi Phoenician Storage Jars from the Site of Jemjim, Southern Lebanon	Dèbora Sandhaus Nysa-Scythopolis: Test Case for Destruction and Abandonment Processes	11:30 – 12:00
Sarah Vilain Is Imitation the Sincerest Form of Flattery? New Light on Local Productions Inspired by Cypriot Wares at Tell el-Dab'a during the Second Intermediate Period	Hélène Sader Excavations at Tell Burak	Sabine Kleiman – Yuval Gadot – Oded Lipschits Disaster in context – investigating a Late Bronze destruction layer at Tel Azekah	12:00 – 12:30
Cydrisse Cateloy Imported Levantine Amphorae at Tell el-Dab'a: A Volumetric Approach to Reconsider the Maritime Trade in the Eastern Mediterranean	Aaron Schmitt Results from the Survey in Southern Lebanon	Amit Dagan At the foot of the mound and along the river bank ... preservation of the destruction layer of the lower city of Biblical Gath	12:30 – 13:00
Lunch break 13:00 – 14:00			
Christina Stantis – Holger Schutkowski Bioarchaeological Investigations of Hyksos Identity and Origins	Chair: Ann Killebrew Southern Levant session Ayelet Gilboa – Ilan Sharon Dor and the Definition of Early Phoenicianism	Igor Kreimerman – Ruth Shahack Gross – Yosef Garfinkel Understanding Conflagration of Mud-Brick Structures at Tel Lachish: Integrating Macro- and Micro-Archaeology	14:00 – 14:30
Nina Maaranen Hidden in Bones - Tracking the Hyksos across the Levant	Carolina Aznar Sanchez Phoenicians in the Southern Akko Plain: Recent Discoveries	Ruth Shahack-Gross – Mathilde Forget – Ron Shaar – Robert Homsher – Erez Hassul – Yael Ebert – Shmuel Marco – Norbert Nowaczyk – Israel Finkelstein – Amotz Agnon Destruction by Fire: The Importance of Understanding Construction Methods and the Effect of Heat on Mud Bricks	14:30 – 15:00
Jozef Hudec The Second Intermediate Period Cemetery at Tell el-Retaba	Michael Jasmin – Yifat Thareani Aspects of the Phoenician Religion: Clay Cultic and Mortuary Masks	Discussion	15:00 – 15:30
Arianna Sacco Connecting the Dots: Using Network Analysis to Examine the Second Intermediate Period	Ann Killebrew Reconstructing Phoenician Iron Production at Tel Akko, Israel		15:30 – 16:00
Coffee 16:00 – 16:30			
Anna-Latifa Mourad The Transformation of the Egyptian Storm God in the Second	Michal Artzy Searching for Tel Akko Phoenician Anchorage/Harbor		16:30 – 17:00
Elisa Priglinger “One ticket to Egypt please!” – Possible Reasons for Human Migration during the First Half of the Second Millennium BC	Aaron Brody Iron IIA/IIB Ceramics from Tel Akko's Area H: Typological Conclusions and Phoenician Connections		17:00 – 17:30

Saturday, 7th of April 2018 – Sections

	Section 1 – A 125 Mobility in the Ancient Near East I	Section 1 – M 105 Mobility in the Ancient Near East II	Section 2 – A 021 Images in Context	Section 5 – A 014 Societal Contexts of Religion
Chair	Haskel Greenfield	Licia Romano	Alessandra Gilibert	Augusta MacMahon
9:00 – 9:30	Dubova Nadezhda and Kufterin Vladimir Paleoanthropological Data from Bronze Age Sites of Southern Turkmenistan and Migration Routes of the Ancient East	Roghayeh Rahimi Sorkhani Mobility in Dalma period on the basis of material culture	Wendy Reade Scenes of the Nile – a Rare Fresco-painted Pavement from Amarna, Egypt	Eloisa Casadei Cooking in the temple. The itinerary of food in Southern Mesopotamian temples during the Third Millennium BC
9:30 – 10:00	Valentina Oselini On the move: is it the vessel or its idea? The Ceramic Horizon of Middle Bronze I-II in the Lower and Middle Diyala Basin	Rasha Elendari Migrating People or Styles? Reinvestigating the “Oval” at Godin Tepe Level VI	Ignacio M. Prieto Vilas The Orientalizing monumental complex from “Poza Moro” (Spain) and its Near Eastern roots and parallels	Roger Matthews Cultic resilience at the dawn of Sumerian cities, 3000-2700 BC: city seals and inter-city cultic processions
10:00 – 10:30	Melania Zingarello Ceramic Grave Goods from Late Third Millennium BC Mesopotamia: A Fresh Look at the So-Called “Four-Part Sets”	Artism Atoosa Investigating the Changes and Transformations of Settlements in Ize Plain from the Beginning of the Neolithic Period to the End of the Chalcolithic Period	Mahta Sheikhi The Impact of Neo-Assyrian Art on Mannaeen Societies of Western and North Western Iran	Christina Tsouparopoulou and Jakob Andersson Communicating with the divine through commemorative objects in 3rd millennium BCE Mesopotamia
10:30 – 11:00	Tina Greenfield Herd Animal Management and mobility in Early Dynastic Sumer	Kamal Asadi and Rahmat Abbasnejad Seresti The Analysis of Chalcolithization of Central Plateau of Iran on the Basis of Archaeometallurgical Data	Sadreddin Taheri Political Iconology of Mythical Creatures in the Achaemenid Architecture	
11:00 – 11:30 Coffee				
Chair	Haskel Greenfield		Silvia Alaura	
11:30 – 12:00	Jill Goulder The use of working donkeys and cattle in 4 th / 3 rd -mill. BC Mesopotamia. social and economic impacts in the light of modern working-animal studies		Marco Ramazzotti The Visual Memory of the Mesopotamian City-State	
12:00 – 12:30	Anna Smogorzewska Pots and people. Mesopotamia-Gulf interaction in the Ubaid period?		Agnes T. Henriksen The visual communication of the Ur excavations 1922-34	
12:30 – 13:00			Rita Dolce The many-faceted power of visual communication and its reception	

13:00 – 14:00 Lunch

14:00 – 15:00 Closing Session

Saturday, 7th of April 2018 – Sections

Section 7 – A 140 Field reports I	Section 7 – M 114 Field reports II	Section 7 – M 118 Field reports III	Section 8 – A 119 Islamic Archaeology	
Simone Mühl	Kai Kaniuth	Felix Blocher	Markus Ritter	Chair
Dlshard Marf Architectural remains in the Sharbazher district, Kurdistan, Iraq	Johanna Lhuillier Julio Bendezu-Sarmiento and Philippe Marquis Ancient Bactra and its Oasis from during Protohistory	Arsen Bobokhyan, Alessandra Gilbert and Pavol Hnila Solving the Enigma of the Dragon Stones. Preliminary results of the Excavations at Karmir Sar on Mount Aragats (Armenia)	Ignacio Arce The "Audience Hall" of Khirbat al-Mafjar, revisited	9:00 – 9:30
Daniele Morandi Bonacossi The Land of Nineveh Archaeological Project. Settlement and Landscape in the Land behind Nineveh between the Bronze and Iron Ages	Steffen Kraus Prehistoric Mining and Metallurgy in Uzbekistan	Iulon Gagoshidze and Elena Roa Kura-Araxes graves at Doghlauri (Georgia): results of the 2012-2015 salvage excavations	Hana Taragan "Woven" Walls: Textile as Power in the Umayyad Palace at Khirbat al Mafjar (Jericho)	9:30 – 10:00
Costanza Coppini The Land of Nineveh Archaeological Project: Middle and Late Bronze Age pottery production and distribution in the Land behind Nineveh	Alexei Fribus Sergei Grushin, Robert Sataev and Nadezhda Dubova Excavations at Gonur Depe BMAC BA Site of Turkmenistan in 2014-2015 Years: Graveyard and Living Spaces on the South-West	Flavia Amato Aradetis Orgora: lithic artefacts of a site of the Southern Caucasus, Georgia	Cristina Tonghini The citadel of Urfa from Late Antiquity to the Ottoman period	10:00 – 10:30
Rafał Koliński Upper Greater Zab Archaeological Reconnaissance (UGZAR) – a summary report		Stephen Batiuk, Mindia Jalabadze and Andrew Graham Report on 2016-17 seasons of The Gadachrili Gora Regional Archaeological Project Ex-pedition (GRAPE)		10:30 – 11:00
Coffee 11:00 – 11:30				
Simone Mühl		Michael Herles		Chair
Ivana Puljiz New perspectives on rural archaeology: excavations at Muqable III		Emanuele E. Intagliata and Davit Naskidashvili Defending the Caucasus in Late Antiquity: first report of the 'Forgotten Borderlands' survey project in southwest Georgia		11:30 – 12:00
		Giulio Palumbi et al. The 2017 investigations at Kiçik Tepe (Tovuz, Azerbaidjan), new data on the neolithic and chalcolithic periods in the Kura river valley		12:00 – 12:30
		Dan Lawrence, Andrea Ricci and Tevekkül Aliyev Mesopotamia without a BA? Long term trends in settlement in the Mil Steppe, Azerbaijan		12:30 – 13:00

Lunch 13:00 – 14:00

Closing Session 14:00 – 15:00

Saturday, 7th of April 2018 - Workshops

Room	A 017	A 119	A016
WS	WS 17 Anja Fügert – Helen Gries Glazed Brick Decoration in the Ancient Near East	WS 18 Susan Cohen – Matthew J. Adams Movement and Mobility between Egypt and the Levant in the Second Millennium BC	WS 19 Kai Wellbrock – Julien Charbonnier – Maurits W. Ertsen Water Studies within Archaeology: towards a synthesis in Archaeohydrology?
9:00 – 9:30	Glaze Technology Parviz Holakoei Glaze Technology in the Iron Age Iran and Iraq: An Overview	Susan Cohen Introduction to Movement and Mobility	Maurits W. Ertsen Welcome & Introducing Archaeohydrology
9:30 – 10:00	Katharina Schmidt Iron Age Mesopotamian Glass Technology	Felix Höflmayer Assessing the Egyptian Activity in the Southern Levant during the Early 18th Dynasty: A Minimalist View	Hans Georg K. Gebel Early human water ethology and commodification as fields of archaeohydrology, explained by early-mid Holocene findings from the Near East
10:00 – 10:30	Glazed Bricks from Iran and Babylonia Olof Pedersén Glazed Brick Decoration in Babylon	Lyndelle Webster Levantine Late Bronze Age Chronology and Egyptian interactions from a Radiocarbon Perspective	Julien Charbonnier Long term evolution of water supply in the oasis of Masafi (UAE): an archaeohydrological approach
10:30 – 11:00	Negar Abdali An Introduction to the Technical Analysis of Iranian Glazes from the Middle Elamite to the Achaemenid Period. Case Study: The Turquoise Glaze from Qalaichi	Vanessa Becker A Re-evaluation of Scarabs during the MB-LB Transition in the Levant: A new approach	Monika Trümper Archaeohydrology and ancient cities: state of research and perspectives
11:00 – 11:30 Coffee break			
11:30 – 12:00	Glazed Bricks from Assyria Anja Fügert – Helen Gries The Reconstruction of the Glazed Brick Facades from Ashur in the Vorderasiatisches Museum (GlAssur-Project)	Ann-Kathrin Jeske Can the archeological record reveal the nature of Egyptian soldier and official activity?	Martin Strauss Tayma Oasis (KSA): Analysis of used methods to answer archaeohydrological key questions and their prospects for future projects
12:00 – 12:30	Manuela Lehmann Nigel Tallis Glazed Tiles From Nimrud And The Visual Narrative Of Esarhadon's Egyptian Campaign	Katharina Streit Assessing the Egyptian influence and the potential of Egyptian presence at Tel Lachish during the Late Bronze Age	Maurits Ertsen Theories and methods in water and archaeology
12:30 – 13:00	Ariane Thomas Glazed Bricks from Khorsabad	Aaron A. Burke Amorites in the Eastern Delta: Reconstructing Interactions in the Early Middle Bronze Age	Julien Charbonnier Introduction for the discussion Discussion
13:00 – 14:00 Lunch break			
14:00 – 14:30	Sebastiano Soldi Glazed Architectural Ceramics in the Iron Age Northern Levant: Two Case Studies from Zincirli and Tell Afis	Matthew J. Adams Thutmose III's Battle of Megiddo: History, Chronology, and the Landscape of Movement	
14:30 – 15:00	Final Discussion		

Layout by Evelyn Kutzer

Logo by Manfred Lerchl

New from UCLPRESS

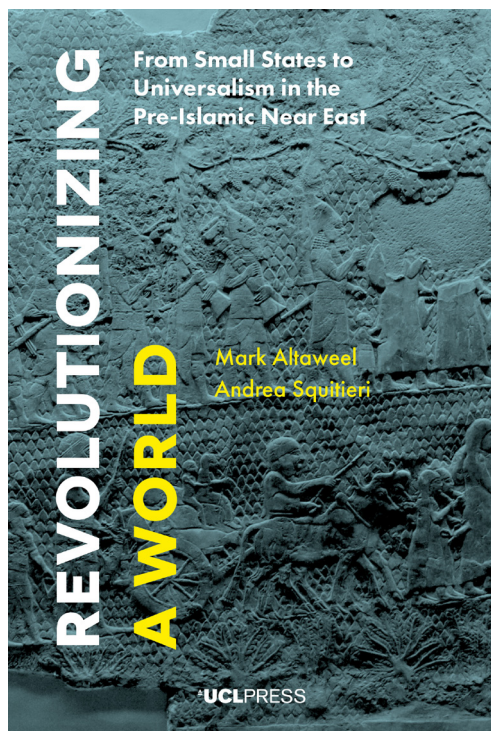

Revolutionizing a World From Small States to Universalism in the Pre-Islamic Near East

Mark Altaweel and Andrea Squitieri

Revolutionizing a World: From Small States to Universalism in the Pre-Islamic Near East investigates the long-term continuity of large-scale states and empires, and its effect on the Near East's social fabric, including the fundamental changes that occurred to major social institutions. Its geographical coverage spans, from east to west, modern-day Libya and Egypt to Central Asia, and from north to south, Anatolia to southern Arabia, incorporating modern-day Oman and Yemen. Its temporal coverage spans from the late eighth century BCE to the seventh century CE during the rise of Islam and collapse of the Sasanian Empire.

336pp | 93 illus.
234mm x 156mm
February 2018

**Free Open Access
Download**

Available free from
ucl.ac.uk/ucl-press

Paperback

ISBN: 978-1-911576-64-8
Price: £25.00

Hardback

ISBN: 978-1-911576-65-5
Price: £45.00

The authors argue that the persistence of large states and empires starting in the eighth/seventh centuries BCE, which continued for many centuries, led to new socio-political structures and institutions emerging in the Near East. The primary processes that enabled this emergence were large-scale and long-distance movements, or population migrations. These patterns of social developments are analysed under different aspects: settlement patterns, urban structure, material culture, trade, governance, language spread and religion, all pointing at movement as the main catalyst for social change. This book's argument is framed within a larger theoretical framework termed as 'universalism', a theory that explains many of the social transformations that happened to societies in the Near East, starting from the Neo-Assyrian period and continuing for centuries. Among other influences, the effects of these transformations are today manifested in modern languages, concepts of government, universal religions and monetized and globalized economies.

Download free from
ucl.ac.uk/ucl-press

